

Prince William Campus
Bull Run Hall Phase II
Space Master Plan
&
Capital Request for 08-10

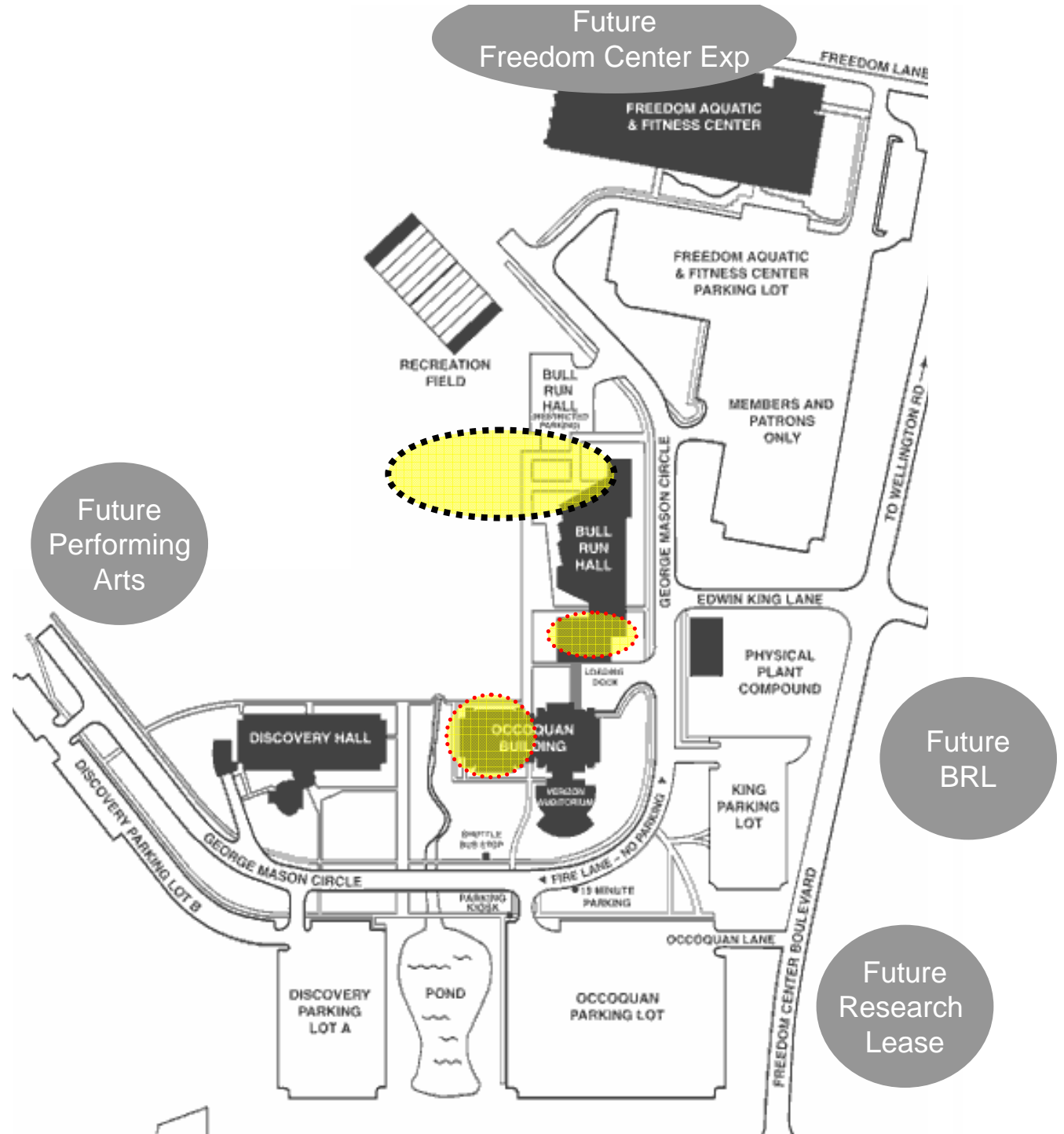

Bull Run Hall – 1st Floor - Proposed

- Volgenau School – IT&E
- Mason Enterprise Center
- Registrar
- ITU
- PW Operations
- Lab Safety

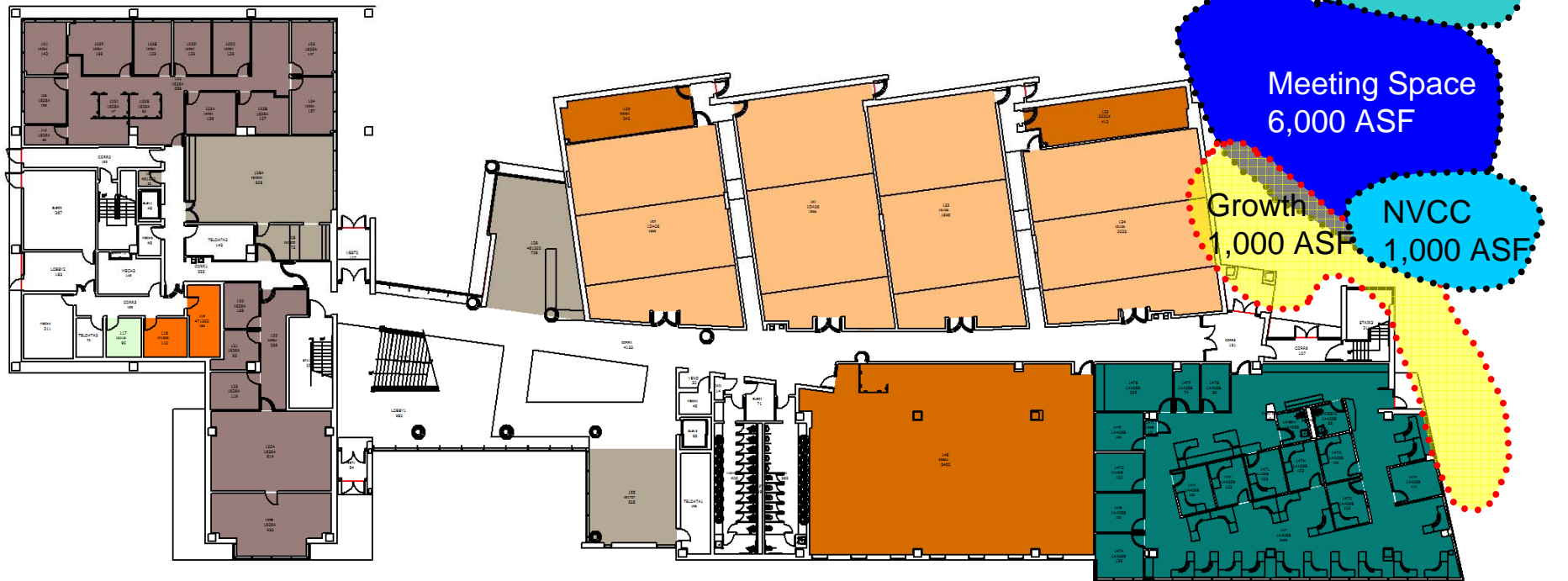

Bull Run Hall – 1st Floor - Proposed

- Volgenau School – IT&E (3800 ASF)
- Mason Enterprise Center
- Registrar
- ITU
- PW Operations
- Lab Safety

- Library 12,500 ASF
- OCPE 2,500 ASF
- Meeting Space 6,000 ASF
- NVCC

IT&E Move Upstairs

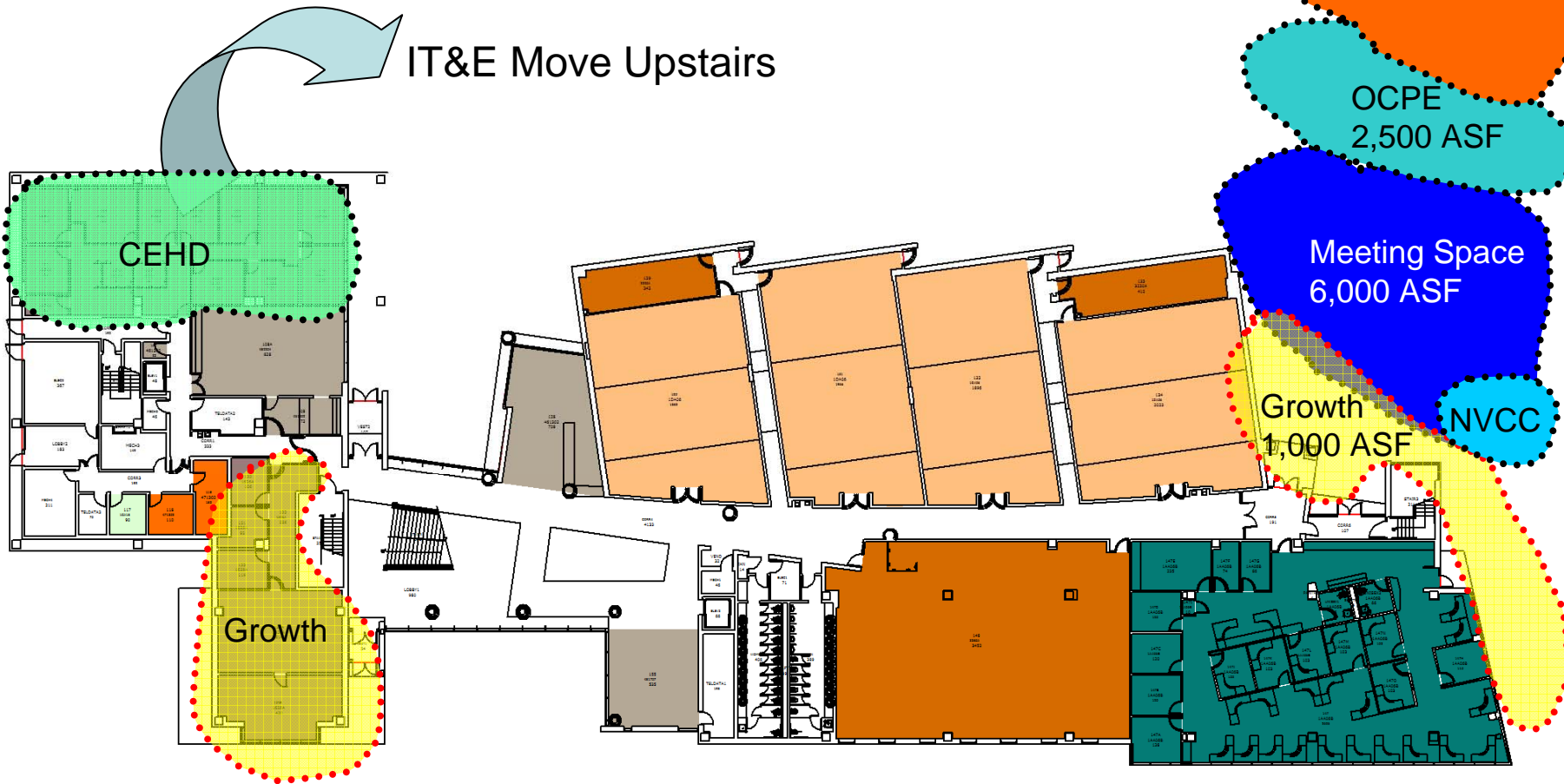

Bull Run Hall – 3rd Floor - Proposed

- College of Science
- College of Humanities and Soc Sci (5500 ASF)
- Lab Safety
- Registrar
- ITU
- PW Operations

CHHS
6,000 ASF

CHSS - ADJ
7,500 ASF

Teaching Labs/
Classrooms
4,000 ASF

Growth
4,500 ASF

ADJ Moves

COS Expansion
5,500 ASF

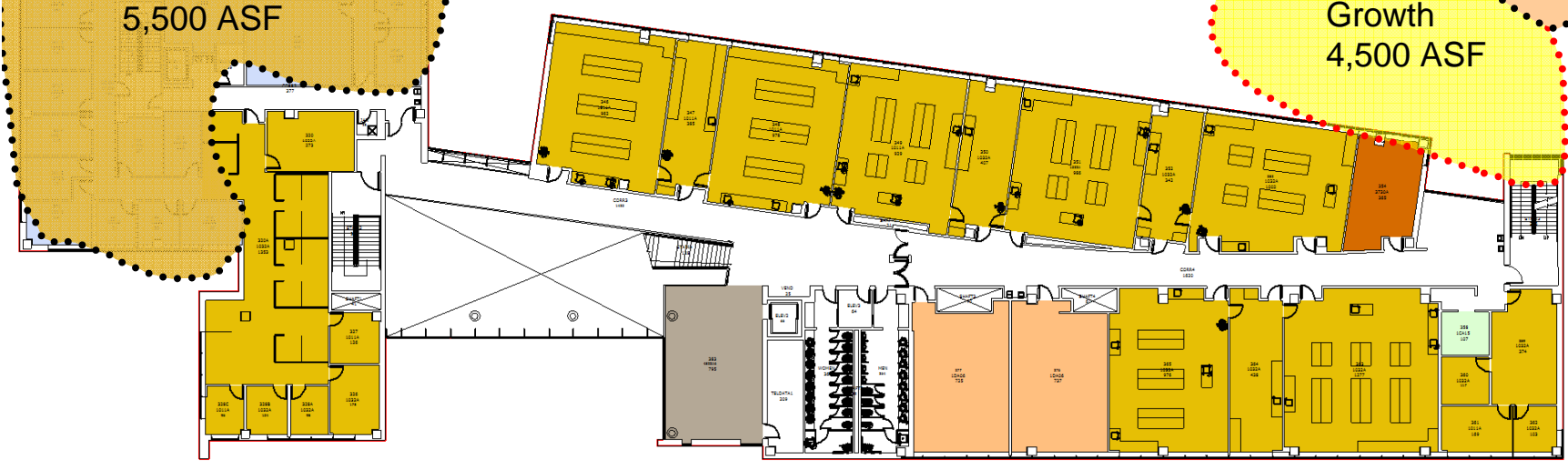

Occoquan – 1st Floor - Proposed

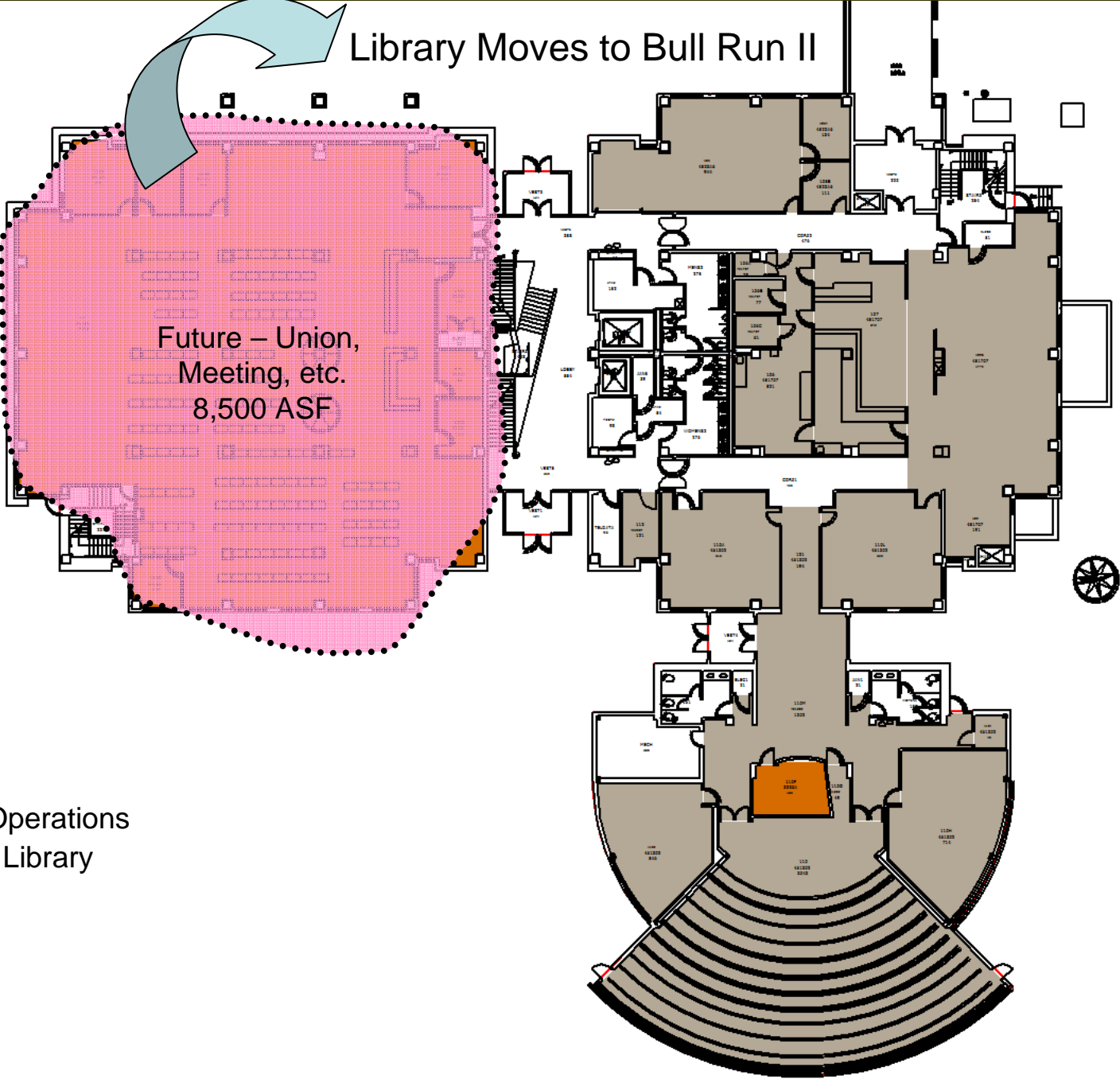

- PW Operations
- ITU - Library

Occoquan – 2nd Floor - Proposed

- CVPA
- UL/Health Clinic
- Registrar
- ITU
- PW Operations
- Lab Safety

Library Support
Moves to Bull Run II

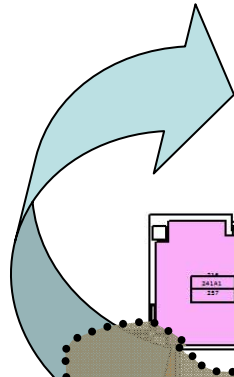

Future Ops
Growth or
Other Admin
Need
1,500 ASF



Occoquan – 3rd Floor - Proposed

- College of Science
- CHHS
- Registrar
- PW Operations
- OCPE

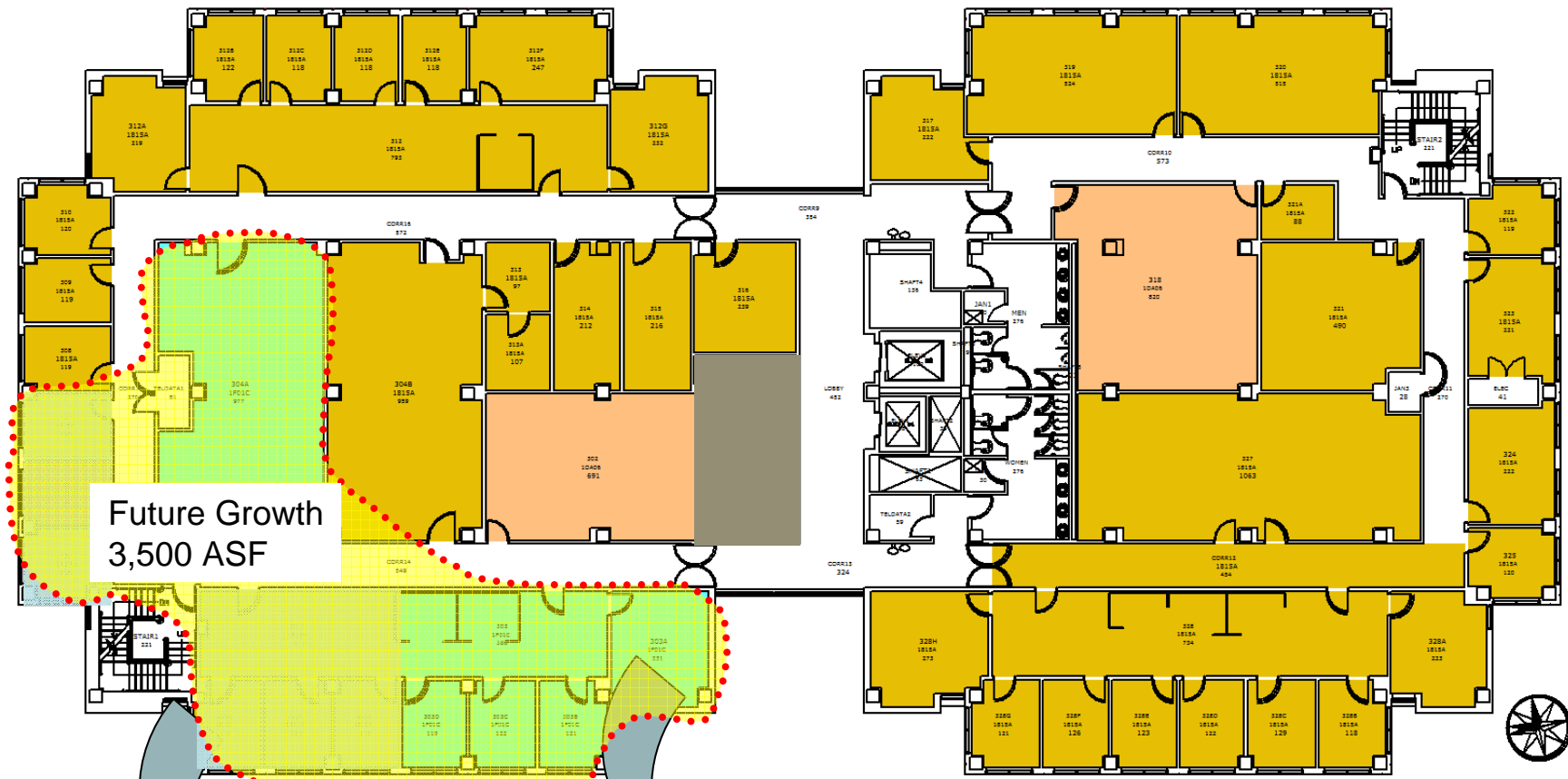

Future Growth
3,500 ASF

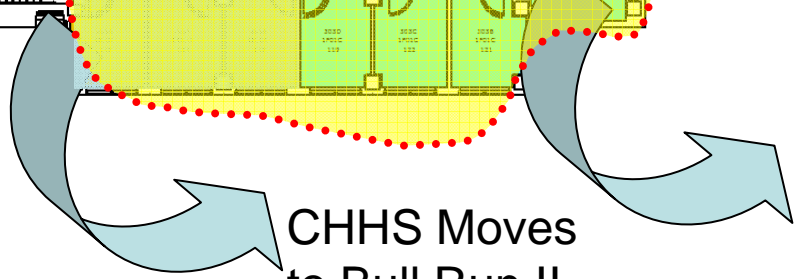

CHHS Moves to Bull Run II

OCPE Moves to Bull Run II