



Survey Control

Reference and Recovery Data

George Mason University

Arlington Campus

Arlington, Virginia



Prepared For:

George Mason University

4400 University Drive

Fairfax, Virginia 22030

Prepared By:

christopher consultants, ltd.

engineering surveying land planning

9417 innovation drive

manassas, virginia 20110

GEORGE MASON UNIVERSITY

GEODETIC SURVEY CONTROL

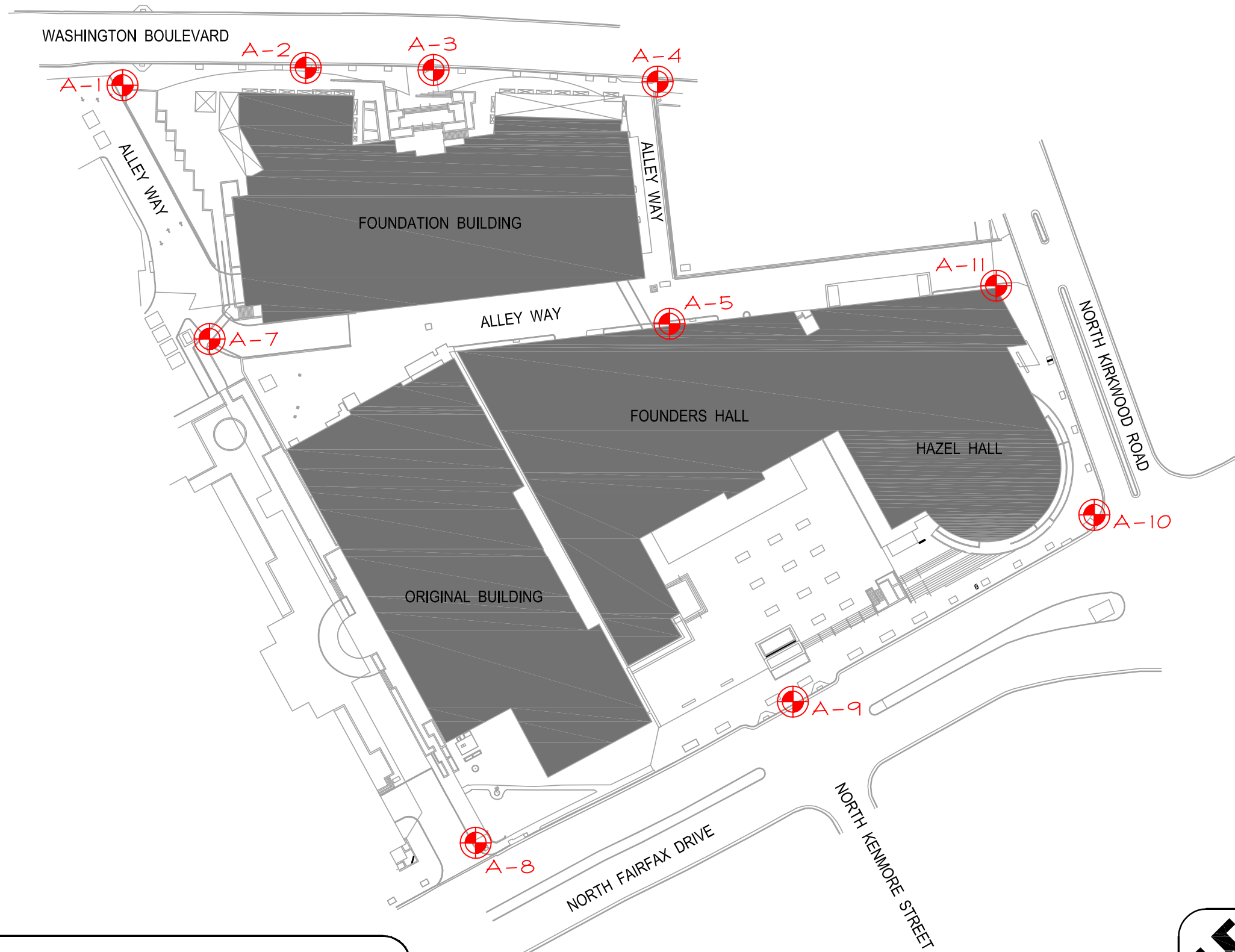

STATION KEY MAP



christopher consultants
engineering - surveying - land planning

9417 Innovation Drive Manassas, VA 20110
703.393.9887 • fax 703.393.9076

GEORGE MASON UNIVERSITY

GEODETIC SURVEY CONTROL

HORIZONTAL DATA

MAP PROJECTION: LAMBERT
 HORIZONTAL DATUM: NORTH AMERICAN DATUM OF 1983 (GEOID 03)
 COORDINATE SYSTEM: VIRGINIA COORDINATE SYSTEM - NORTH (4501)

GRID NORTHING: 7,008,732.154
 GRID EASTING: 11,880,654.709

LATITUDE: 38°53'09.50767" N
 LONGITUDE: 77°06'09.58318" W

GMU PROJECT NORTHING: 7,008,732.154
 GMU PROJECT EASTING: 11,880,654.709

CONVERGENCE ('): \ominus 00°52'19.6"
 COMBINED FACTOR: 0.999952124
 AVG. COMBINED FACTOR: 0.999952191 (PROJECT)

VERTICAL DATA

VERTICAL DATUM: NORTH AMERICAN VERTICAL DATUM OF 1988 (NAVD 88)
 ELEVATION: 255.58

PHOTO AT STATION:



STATION DESIGNATION

A-01

UNITS: U.S. SURVEY FOOT
 CONVERSION: 1 FOOT = 0.3048 M

LOCATION SKETCH

(NOT TO SCALE)

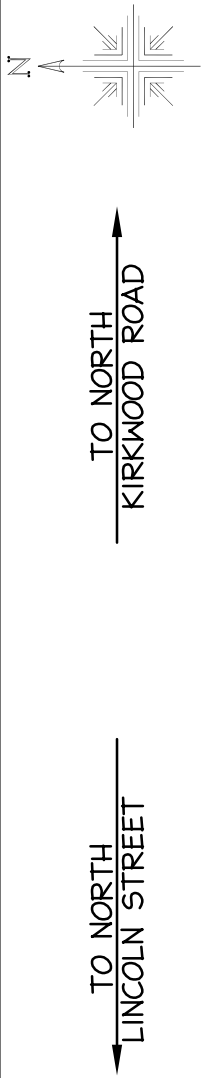

WASHINGTON BOULEVARD

EDGE OF PAVEMENT

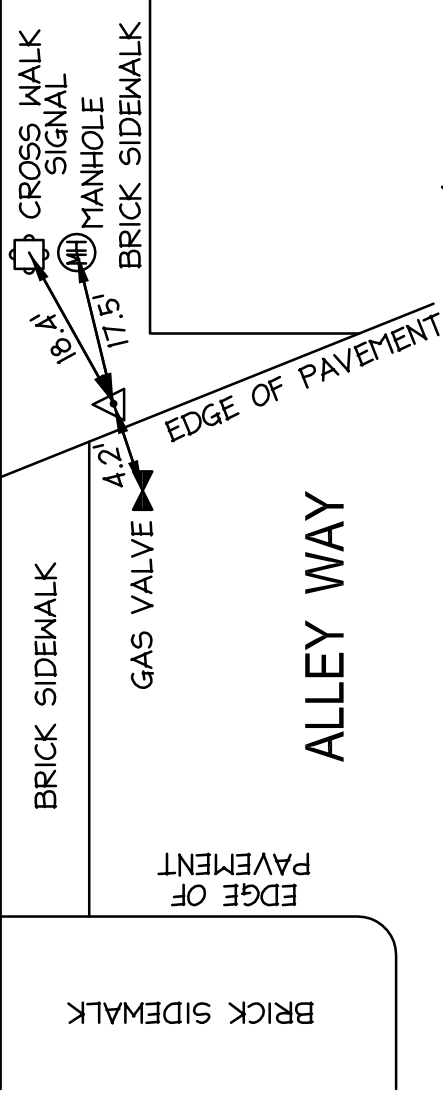

christopher consultants
 engineering - surveying - land planning

9417 Innovation Drive Manassas, VA 20110
 703.393.9887 • fax 703.393.9076

MONUMENT:
**4' x 4' x 2' CONCRETE
 MONUMENT WITH 2"
 STAMPED ALUMINUM CAP**
 DATE SET: **MAY 2012**

PROJECT NO. : 83026.043.28
 SET BY : M. LOVELAND
 PREPARED BY : C. FILLMORE
 FIELD BOOK(S) : FB. 427 PG. 24-31

GEORGE MASON UNIVERSITY

GEODETIC SURVEY CONTROL

HORIZONTAL DATA

MAP PROJECTION: LAMBERT
 HORIZONTAL DATUM: NORTH AMERICAN DATUM OF 1983 (GEOID 03)
 COORDINATE SYSTEM: VIRGINIA COORDINATE SYSTEM - NORTH (4501)

GRID NORTHING:	7,008,737.775	GRID EASTING:	11,880,813.249
LATITUDE:	38°53'09.53936" N	LONGITUDE:	77°06'07.57727" W
GMU PROJECT NORTHING:	7,008,737.775	GMU PROJECT EASTING:	11,880,813.249

CONVERGENCE ('): \ominus 00°52'20.8"
 COMBINED FACTOR: 0.999952255
 AVG. COMBINED FACTOR: 0.999952191 (PROJECT)

VERTICAL DATA

VERTICAL DATUM: NORTH AMERICAN VERTICAL DATUM OF 1988 (NAVD 88)
 ELEVATION: 252.84
 PHOTO AT STATION:

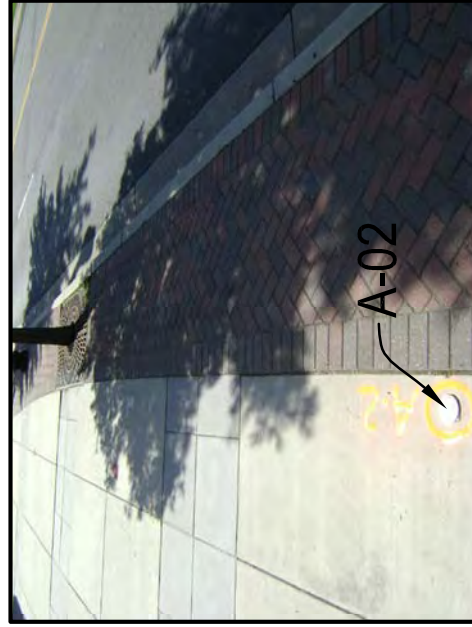

STATION DESIGNATION

A-02

UNITS: U.S. SURVEY FOOT
 CONVERSION: 1 FOOT = 0.3048 M

LOCATION SKETCH

(NOT TO SCALE)

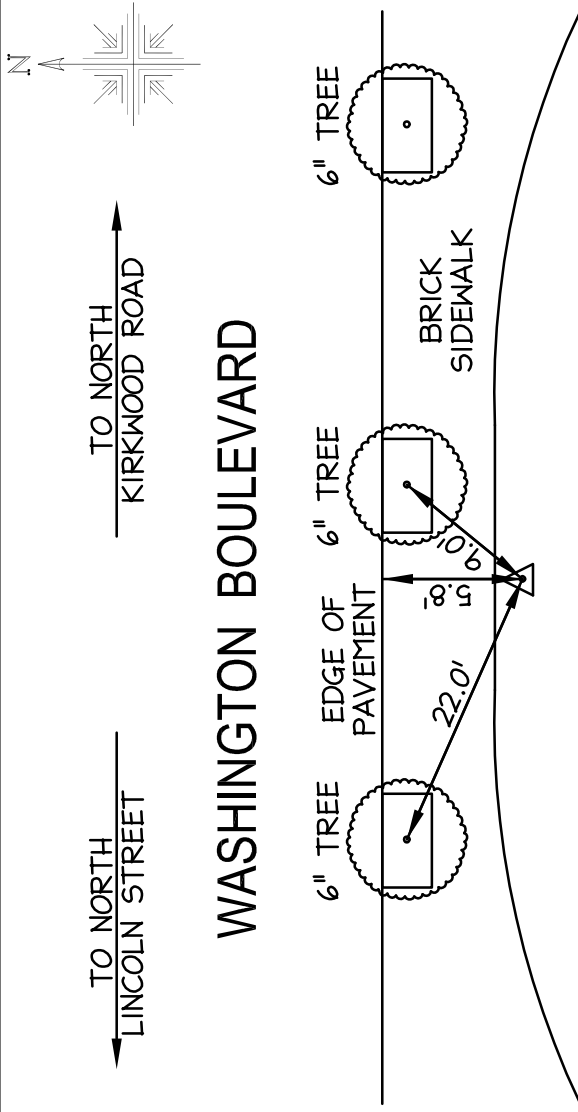

CONCRETE SIDEWALK

FOUNDATION BUILDING



christopher consultants
 engineering - surveying - land planning
 9417 Innovation Drive Manassas, VA 20110
 703.393.9887 • fax 703.393.9076

MONUMENT:
**4" x 4" x 2' CONCRETE
 MONUMENT WITH 2"
 STAMPED ALUMINUM CAP**
 DATE SET: **MAY 2012**

PROJECT NO. : 83026.043.28
 SET BY : M. LOVELAND
 PREPARED BY : C. FILLMORE
 FIELD BOOK(S) : FB. 427 PG. 24-31

GEORGE MASON UNIVERSITY

GEODETIC SURVEY CONTROL

HORIZONTAL DATA

MAP PROJECTION: LAMBERT
 HORIZONTAL DATUM: NORTH AMERICAN DATUM OF 1983 (GEOID 03)
 COORDINATE SYSTEM: VIRGINIA COORDINATE SYSTEM - NORTH (4501)

GRID NORTHING: 7,008,736.263
 GRID EASTING: 11,880,919.742

LATITUDE: 38°53'09.50839" N
 LONGITUDE: 77°06'06.23089" W

GMU PROJECT NORTHING: 7,008,736.263
 GMU PROJECT EASTING: 11,880,919.742

CONVERGENCE ('): \ominus 00°52'21.6"

COMBINED FACTOR: 0.999952470

AVG. COMBINED FACTOR: 0.999952191 (PROJECT)

VERTICAL DATA

VERTICAL DATUM: NORTH AMERICAN VERTICAL DATUM OF 1988 (NAVD 88)

ELEVATION: 248.33

PHOTO AT STATION:



STATION DESIGNATION

A-03

UNITS: U.S. SURVEY FOOT
 CONVERSION: 1 FOOT = 0.3048 M

LOCATION SKETCH

(NOT TO SCALE)

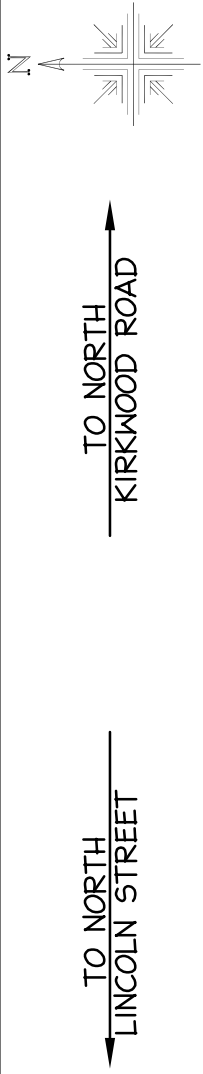

WASHINGTON BOULEVARD

EDGE OF PAVEMENT

CONCRETE PAVERS

COMMUNICATION VAULT

BRICK SIDEWALK

CONCRETE PAVERS

CONCRETE SIDEWALK

BRICK SIDEWALK

CONCRETE STAIRS

CONCRETE SIDEWALK



MONUMENT:
**4" x 4" x 2' CONCRETE
 MONUMENT WITH 2"
 STAMPED ALUMINUM CAP**
 DATE SET: **MAY 2012**



christopher consultants
 engineering - surveying - land planning
 9417 Innovation Drive Manassas, VA 20110
 703.393.9887 • fax 703.393.9076

GEORGE MASON UNIVERSITY

GEODETIC SURVEY CONTROL

HORIZONTAL DATA

MAP PROJECTION: LAMBERT
 HORIZONTAL DATUM: NORTH AMERICAN DATUM OF 1983 (GEOID 03)
 COORDINATE SYSTEM: VIRGINIA COORDINATE SYSTEM - NORTH (4501)

GRID NORTHING: 7,008,716.584
 GRID EASTING: 11,881,096.842

LATITUDE: 38°53'09.28722" N
 LONGITUDE: 77°06'03.99514" W

GMU PROJECT NORTHING: 7,008,716.584
 GMU PROJECT EASTING: 11,881,096.842

CONVERGENCE ('): \ominus 00°52'23.1"

COMBINED FACTOR: .999953022

AVG. COMBINED FACTOR: 0.999952191 (PROJECT)

VERTICAL DATA

VERTICAL DATUM: NORTH AMERICAN VERTICAL DATUM OF 1988 (NAVD 88)

ELEVATION: 236.69

PHOTO AT STATION:



STATION DESIGNATION

A-04

UNITS: U.S. SURVEY FOOT
 CONVERSION: 1 FOOT = 0.3048 M

LOCATION SKETCH

(NOT TO SCALE)

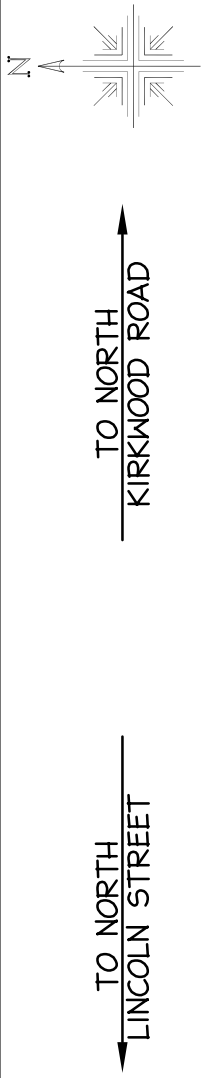

WASHINGTON BOULEVARD

EDGE OF PAVEMENT

UTILITY POLE

BRICK SIDEWALK

COMMUNICATION VAULT

EDGE OF CONCRETE
 EDGE OF PAVEMENT

ALLEY WAY

CONCRETE WALL

CONCRETE SIDEWALK



MONUMENT:
**4' x 4' x 2' CONCRETE
 MONUMENT WITH 2"
 STAMPED ALUMINUM CAP**
 DATE SET: **MAY 2012**

christopher consultants
 engineering - surveying - land planning

9417 Innovation Drive Manassas, VA 20110
 703.393.9887 • fax 703.393.9076

PROJECT NO. : 83026.043.28
 SET BY : M. LOVELAND
 PREPARED BY : C. FILLMORE
 FIELD BOOK(S) : FB. 427 PG. 24-31

GEORGE MASON UNIVERSITY

GEODETIC SURVEY CONTROL

HORIZONTAL DATA

MAP PROJECTION:	LAMBERT		
HORIZONTAL DATUM:	NORTH AMERICAN DATUM OF 1983 (GEOID 03)		
COORDINATE SYSTEM:	VIRGINIA COORDINATE SYSTEM - NORTH (4501)		
GRID NORTHING:	7,008,533.934	GRID EASTING:	11,881,110.055
LATITUDE:	38°53'07.48001" N	LONGITUDE:	77°06'03.86326" W
GMU PROJECT NORTHING:	7,008,533.934	GMU PROJECT EASTING:	11,881,110.055
CONVERGENCE ('): \ominus	00°52'23.1"		
COMBINED FACTOR:	0.999952813		
AVG. COMBINED FACTOR:	0.999952191 (PROJECT)		

VERTICAL DATA

VERTICAL DATUM:	NORTH AMERICAN VERTICAL DATUM OF 1988 (NAVD 88)		
ELEVATION:	240.21		
PHOTO AT STATION:			



STATION DESIGNATION

A-05

UNITS: U.S. SURVEY FOOT
CONVERSION: 1 FOOT = 0.3048 M

LOCATION SKETCH

(NOT TO SCALE)

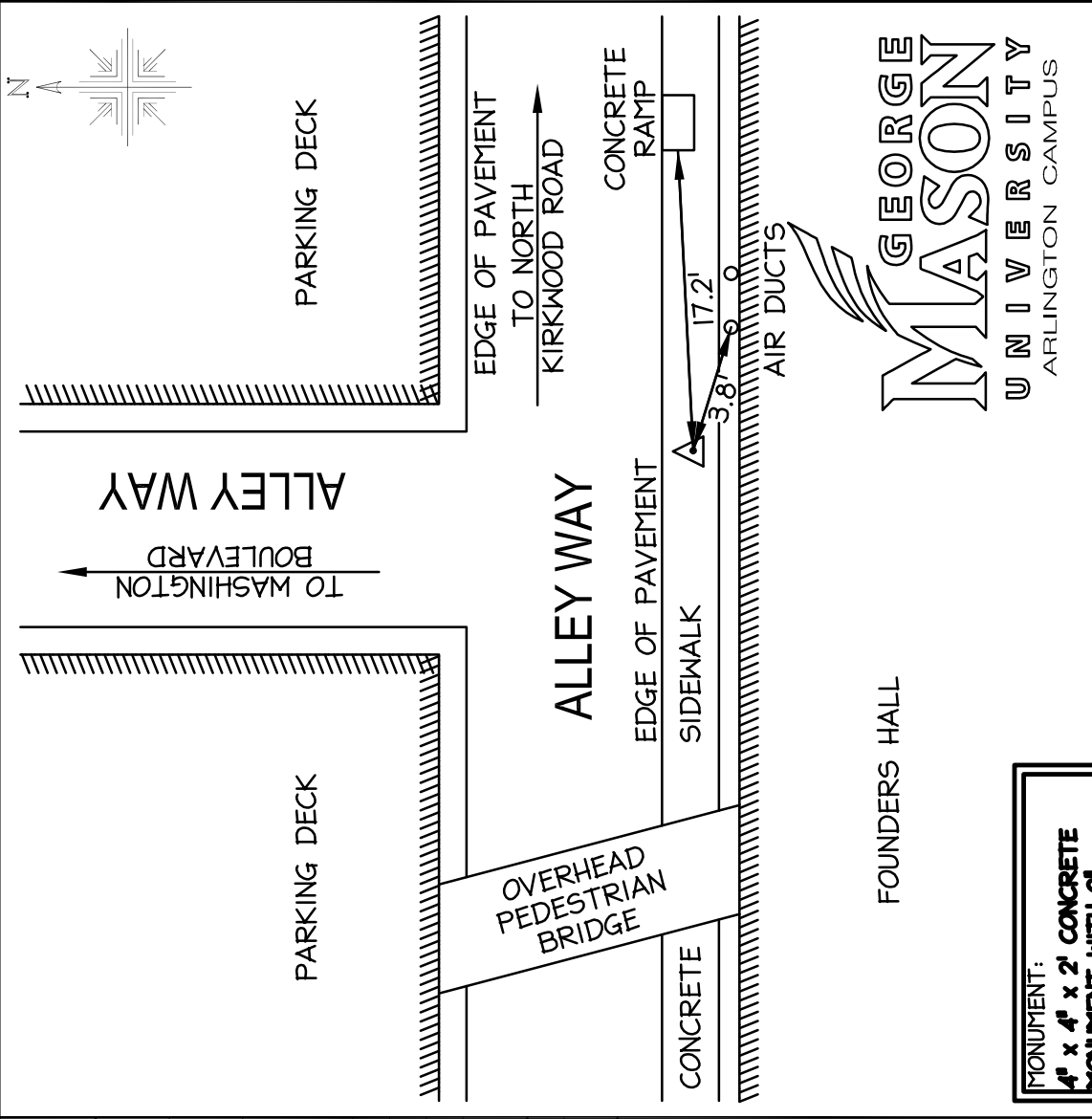

MONUMENT:
4" x 4" x 2' CONCRETE
MONUMENT WITH 2"
STAMPED ALUMINUM CAP
DATE SET: MAY 2012



christopher consultants
 engineering - surveying - land planning
 9417 Innovation Drive Manassas, VA 20110
 703.393.9887 • fax 703.393.9076

PROJECT NO. : 83026.043.28
 SET BY : M. LOVELAND
 PREPARED BY : C. FILLMORE
 FIELD BOOK(S) : FB. 427 PG. 24-31

GEORGE MASON UNIVERSITY

GEODETIC SURVEY CONTROL

HORIZONTAL DATA

MAP PROJECTION: LAMBERT	
HORIZONTAL DATUM: NORTH AMERICAN DATUM OF 1983 (GEOID 03)	
COORDINATE SYSTEM: VIRGINIA COORDINATE SYSTEM - NORTH (4501)	
GRID NORTHING:	7,008,519.059
GRID EASTING:	11,880,734.666
LATITUDE:	38°53'07.38951" N
LONGITUDE:	77°06'08.61311" W
GMU PROJECT NORTHING:	7,008,519.059
GMU PROJECT EASTING:	11,880,734.666
CONVERGENCE ('): \ominus	00°52'20.2"
COMBINED FACTOR:	0.999951923
AVG. COMBINED FACTOR:	0.999952191 (PROJECT)

VERTICAL DATA

VERTICAL DATUM:	NORTH AMERICAN VERTICAL DATUM OF 1988 (NAVD 88)
ELEVATION:	258.77
PHOTO AT STATION:	



STATION DESIGNATION

A-07

LOCATION SKETCH

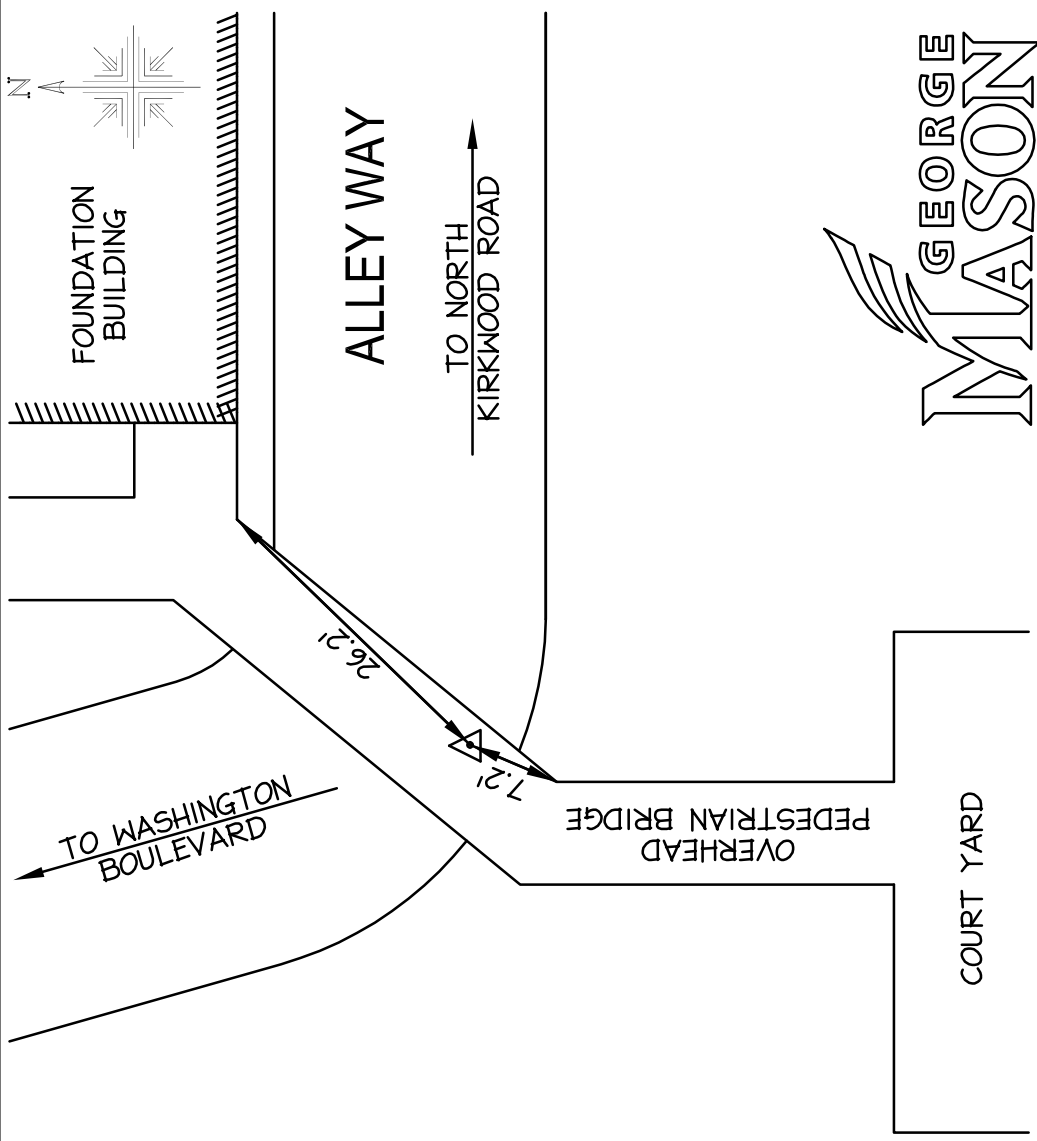

MONUMENT:
4' x 4' x 2' CONCRETE
MONUMENT WITH 2"
STAMPED ALUMINUM CAP
DATE SET: MAY 2012

PROJECT NO. : 83026.043.28
 SET BY : M. LOVELAND
 PREPARED BY : C. FILLMORE
 FIELD BOOK(S) : FB. 427 PG. 24-31

(NOT TO SCALE)



christopher consultants
 engineering - surveying - land planning
 9417 Innovation Drive Manassas, VA 20110
 703.393.9887 • fax 703.393.9076

GEORGE MASON UNIVERSITY

GEODETIC SURVEY CONTROL

HORIZONTAL DATA

MAP PROJECTION: LAMBERT	
HORIZONTAL DATUM: NORTH AMERICAN DATUM OF 1983 (GEOID 03)	
COORDINATE SYSTEM: VIRGINIA COORDINATE SYSTEM - NORTH (4501)	
GRID NORTHING:	7,008,098.819
LATITUDE:	38°53'03.20150" N
GMU PROJECT NORTHING:	7,008,089.819
GRID EASTING:	11,880,964.342
LONGITUDE:	77°06'05.78970" W
GMU PROJECT EASTING:	11,880,964.342
CONVERGENCE ('): \ominus	00°52'21.9"
COMBINED FACTOR:	0.999951970
AVG. COMBINED FACTOR:	0.999952191 (PROJECT)

VERTICAL DATA

VERTICAL DATUM: NORTH AMERICAN VERTICAL DATUM OF 1988 (NAVD 88)
ELEVATION: 255.83
PHOTO AT STATION:



STATION DESIGNATION

A-08

LOCATION SKETCH

(NOT TO SCALE)

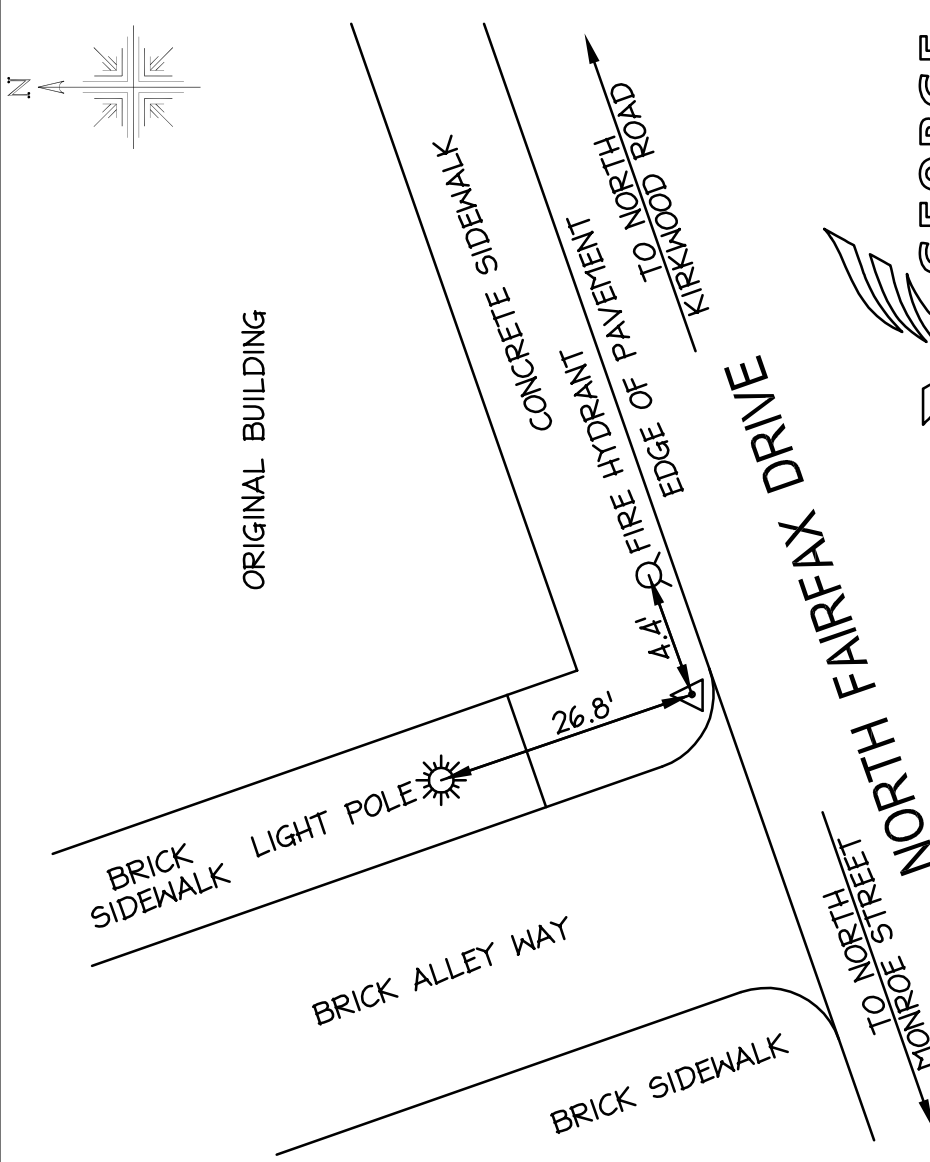

MONUMENT:
**4" x 4" x 2' CONCRETE
 MONUMENT WITH 2"
 STAMPED ALUMINUM CAP**
 DATE SET: **MAY 2012**

christopher consultants
 engineering - surveying - land planning

9417 Innovation Drive Manassas, VA 20110
 703.393.9887 • fax 703.393.9076

PROJECT NO. :	83026.043.28
SET BY :	M. LOVELAND
PREPARED BY :	C. FILLMORE
FIELD BOOK(S) :	FB. 427 PG. 24-31

UNITS:	U.S. SURVEY FOOT
CONVERSION:	1 FOOT = 0.3048 M

GEORGE MASON UNIVERSITY

GEODETIC SURVEY CONTROL

HORIZONTAL DATA

MAP PROJECTION: LAMBERT	
HORIZONTAL DATUM: NORTH AMERICAN DATUM OF 1983 (GEOID 03)	
COORDINATE SYSTEM: VIRGINIA COORDINATE SYSTEM - NORTH (4501)	
GRID NORTHING:	GRID EASTING:
7,008,234.426	11,881,200.855
LATITUDE:	LONGITUDE:
38°53'04.50615" N	77°06'02.77278" W
GMU PROJECT NORTHING:	GMU PROJECT EASTING:
7,008,234.426	11,881,200.855
CONVERGENCE ('): \ominus	00°52'23.8"
COMBINED FACTOR:	0.999951860
AVG. COMBINED FACTOR:	0.999952191 (PROJECT)

VERTICAL DATA

VERTICAL DATUM: NORTH AMERICAN VERTICAL DATUM OF 1988 (NAVD 88)
ELEVATION: 258.74
PHOTO AT STATION:



STATION DESIGNATION

A-09

UNITS: U.S. SURVEY FOOT
 CONVERSION: 1 FOOT = 0.3048 M

LOCATION SKETCH

(NOT TO SCALE)

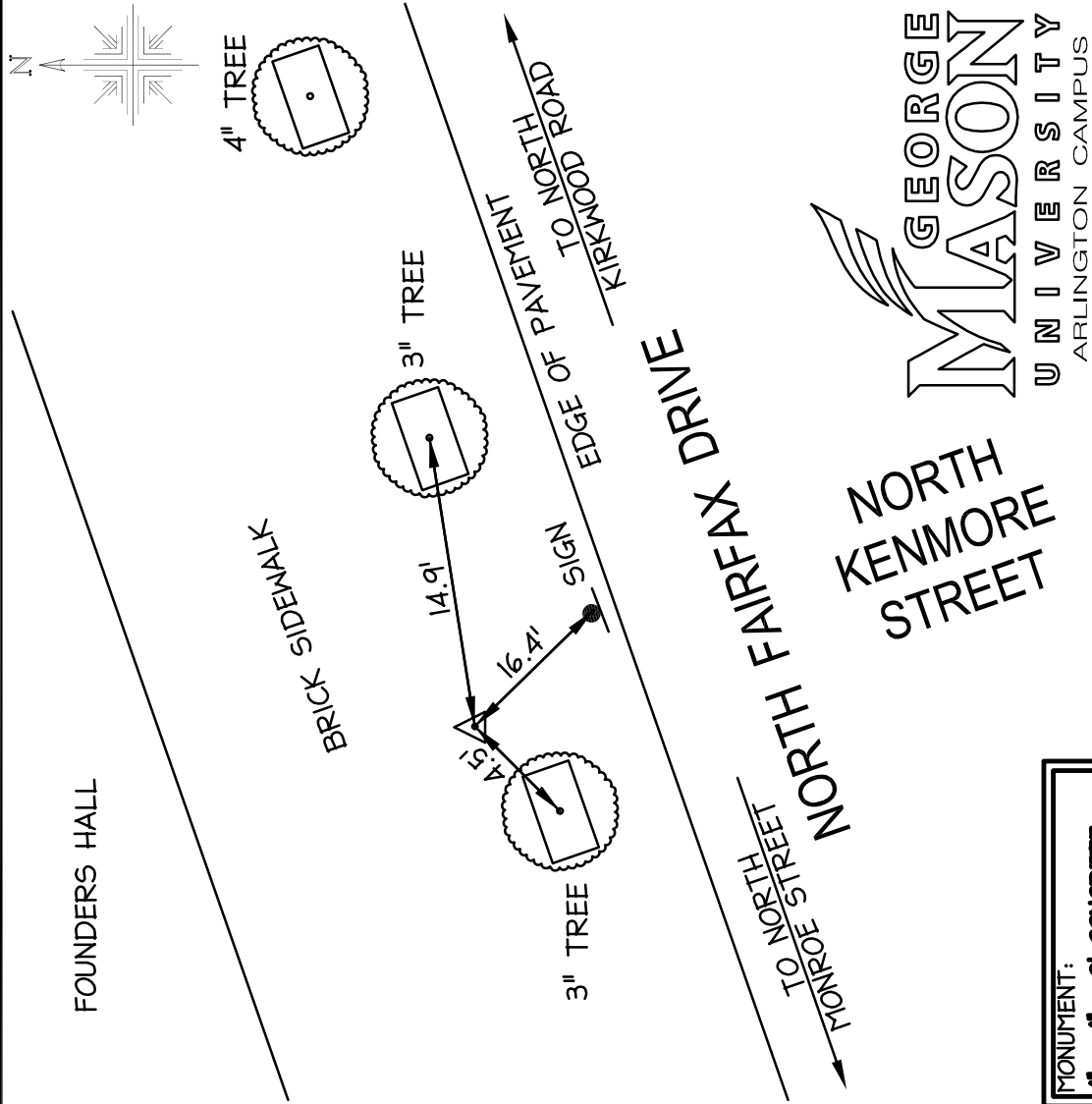

MONUMENT:
**4" x 4" x 2' CONCRETE
 MONUMENT WITH 2"
 STAMPED ALUMINUM CAP**
 DATE SET: **MAY 2012**



christopher consultants
 engineering - surveying - land planning

9417 Innovation Drive Manassas, VA 20110
 703.393.9887 • fax 703.393.9076

PROJECT NO. : 83026.043.28
 SET BY : M. LOVELAND
 PREPARED BY : C. FILLMORE
 FIELD BOOK(S) : FB. 427 PG. 24-31

GEORGE MASON UNIVERSITY

GEODETIC SURVEY CONTROL

HORIZONTAL DATA

MAP PROJECTION: LAMBERT	
HORIZONTAL DATUM: NORTH AMERICAN DATUM OF 1983 (GEOID 03)	
COORDINATE SYSTEM: VIRGINIA COORDINATE SYSTEM - NORTH (4501)	
GRID NORTHING:	7,008,376.399
LATITUDE:	38°53'05.87069" N
GMU PROJECT NORTHING:	7,008,376.399
GRID EASTING:	11,881,457.382
LONGITUDE:	77°05'59.50151" W
GMU PROJECT EASTING:	11,881,457.382
CONVERGENCE ('): \ominus	00°52'25.8"
COMBINED FACTOR:	0.999952132
AVG. COMBINED FACTOR:	0.999952191 (PROJECT)

VERTICAL DATA

VERTICAL DATUM:	NORTH AMERICAN VERTICAL DATUM OF 1988 (NAVD 88)
ELEVATION:	253.70

PHOTO AT STATION:



STATION DESIGNATION

A-10

UNITS: U.S. SURVEY FOOT
CONVERSION: 1 FOOT = 0.3048 M

LOCATION SKETCH

(NOT TO SCALE)

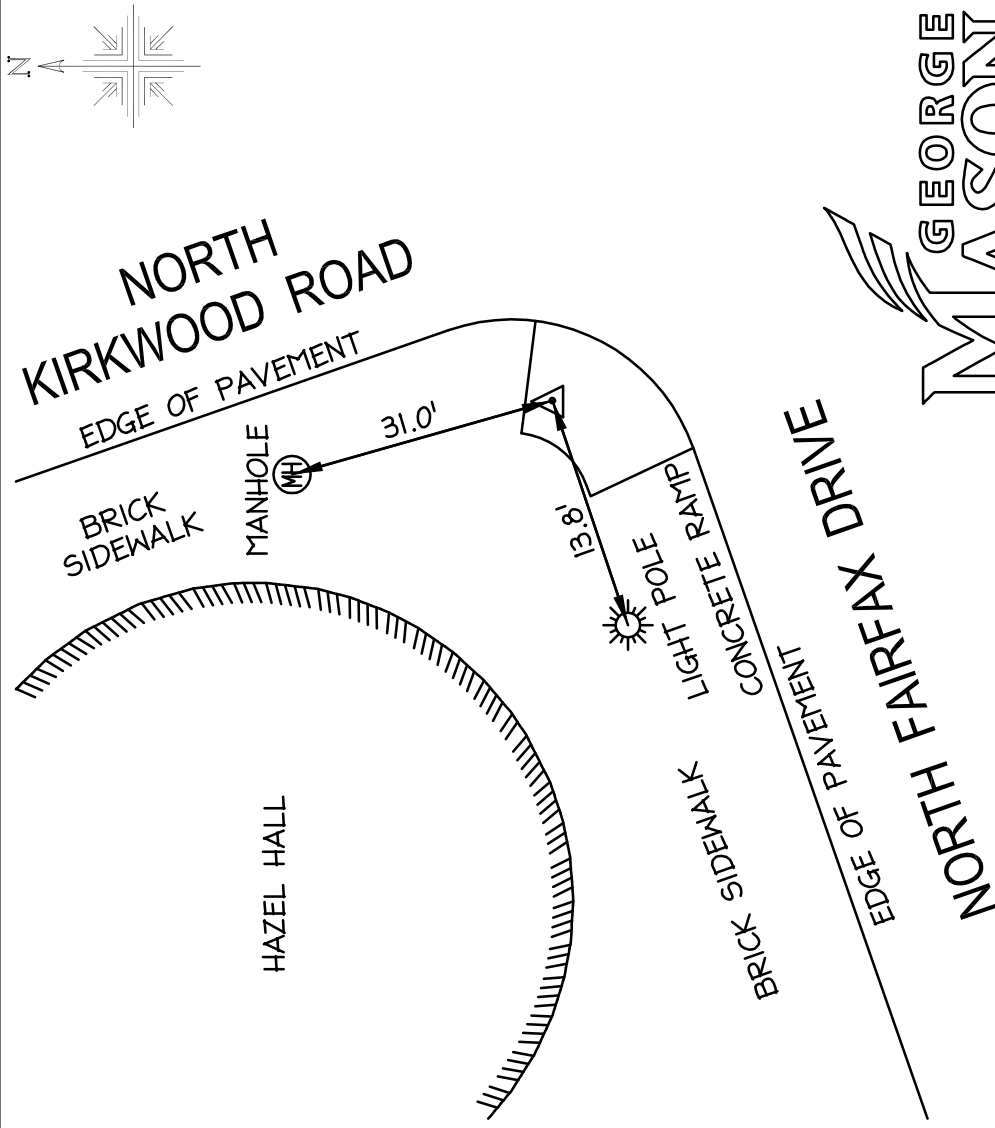

MONUMENT:
**4' x 4' x 2' CONCRETE
 MONUMENT WITH 2"
 STAMPED ALUMINUM CAP**
 DATE SET: **MAY 2012**

GEORGE MASON UNIVERSITY
ARLINGTON CAMPUS

christopher consultants
 engineering - surveying - land planning

9417 Innovation Drive Manassas, VA 20110
 703.393.9887 • fax 703.393.9076

PROJECT NO. : 83026.043.28
 SET BY : M. LOVELAND
 PREPARED BY : C. FILLMORE
 FIELD BOOK(S) : FB. 427 PG. 24-31

GEORGE MASON UNIVERSITY

GEODETIC SURVEY CONTROL

HORIZONTAL DATA

MAP PROJECTION: LAMBERT
 HORIZONTAL DATUM: NORTH AMERICAN DATUM OF 1983 (GEOID 03)
 COORDINATE SYSTEM: VIRGINIA COORDINATE SYSTEM - NORTH (4501)

GRID NORTHING: 7,008,565.992
 GRID EASTING: 11,881,393.717
 LATITUDE: 38°53'07.75412" N
 LONGITUDE: 77°06'00.27004" W
 GMU PROJECT NORTHING: 7,008,565.992
 GMU PROJECT EASTING: 11,881,393.717

CONVERGENCE ('): \ominus 00°52'25.4"
 COMBINED FACTOR: 0.999952490
 AVG. COMBINED FACTOR: 0.999952191 (PROJECT)

VERTICAL DATA

VERTICAL DATUM: NORTH AMERICAN VERTICAL DATUM OF 1988 (NAVD 88)
 ELEVATION: 247.09

PHOTO AT STATION:

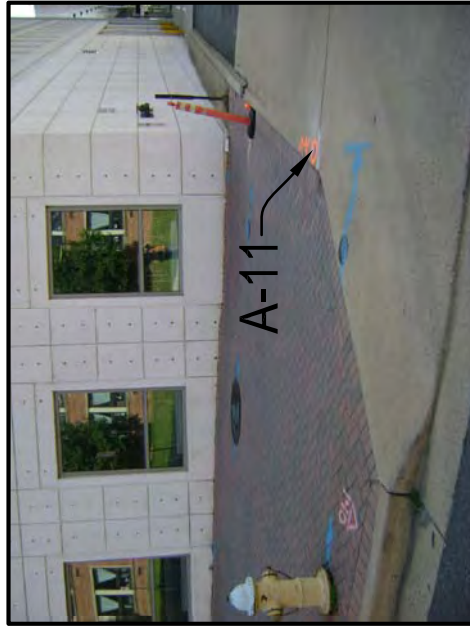

STATION DESIGNATION

A-11

UNITS:
 CONVERSION:

U.S. SURVEY FOOT
 1 FOOT = 0.3048 M

LOCATION SKETCH

(NOT TO SCALE)

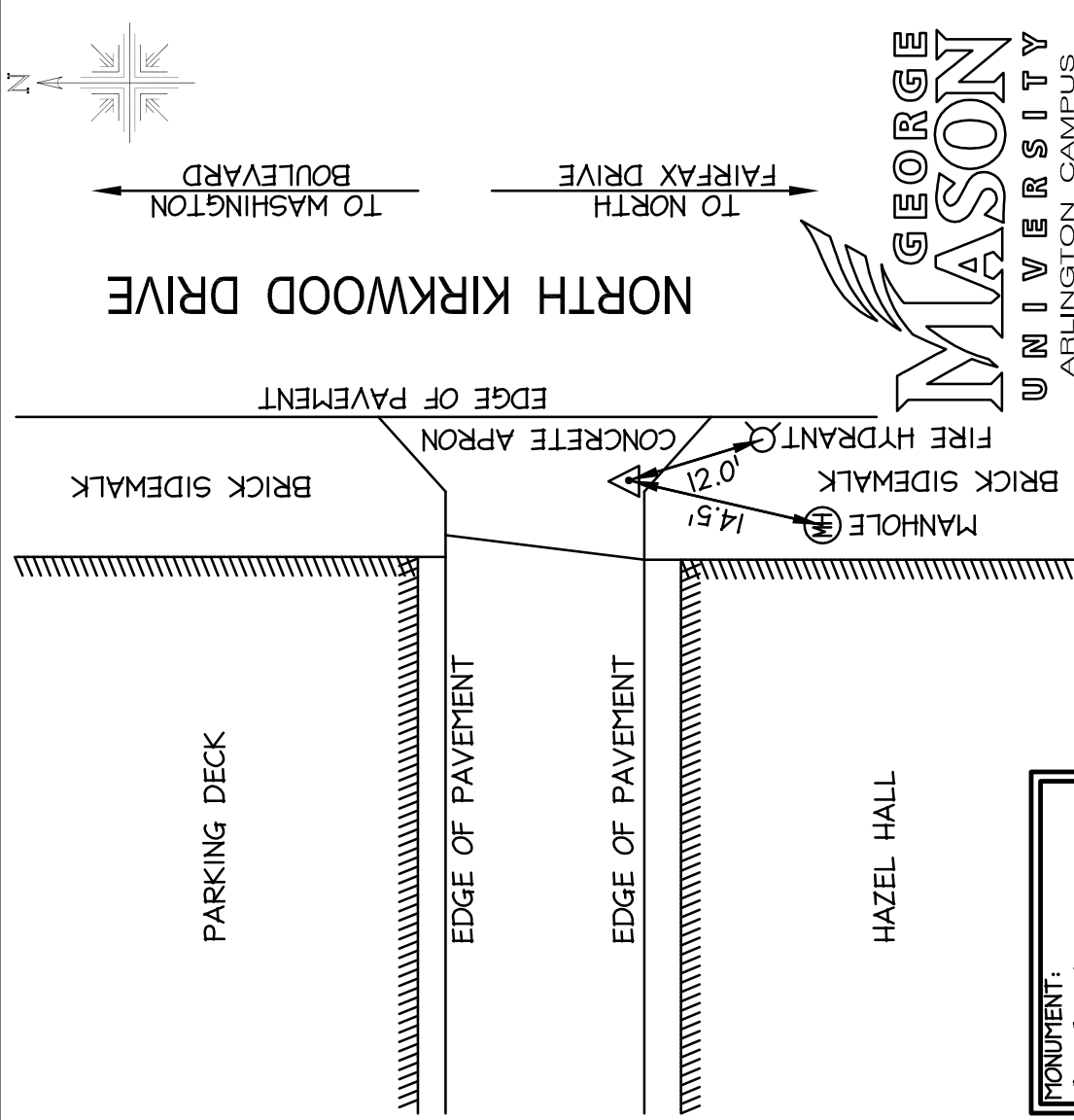

MONUMENT:
**4' x 4' x 2' CONCRETE
 MONUMENT WITH 2"
 STAMPED ALUMINUM CAP**
 DATE SET: **MAY 2012**

christopher consultants
 engineering - surveying - land planning

9417 Innovation Drive Manassas, VA 20110
 703.393.9887 • fax 703.393.9076

PROJECT NO. : 83026.043.28
 SET BY : M. LOVELAND
 PREPARED BY : C. FILLMORE
 FIELD BOOK(S) : FB. 427 PG. 24-31

