

George Mason University

BULL RUN HALL 2, ACADEMIC VIII, &
DISCOVERY PROGRAMMING KICKOFF

May 10, 2019

EYP/





OVERVIEW



Architect/Engineer Team

Architect	EYP
MEP	Mueller Associates Inc.
Structural	Cagley & Associates
Civil	GORDON
Landscape	Rhodeside & Harwell
Lighting Designer	MCLA
AV/IT/Acoustics	The Sextant Group
Cost Estimating	Forella Group LLC
Specifications	Sue McClymonds





John Baxter
Project Executive



Suzanne Klein
Project Director



Melissa Burns
Academic Planner



Brian Tucker
Lab Planner



Rick Clarke
Lead Designer





Sci Tech Instructional & Academic Support Space – 3550 FTE

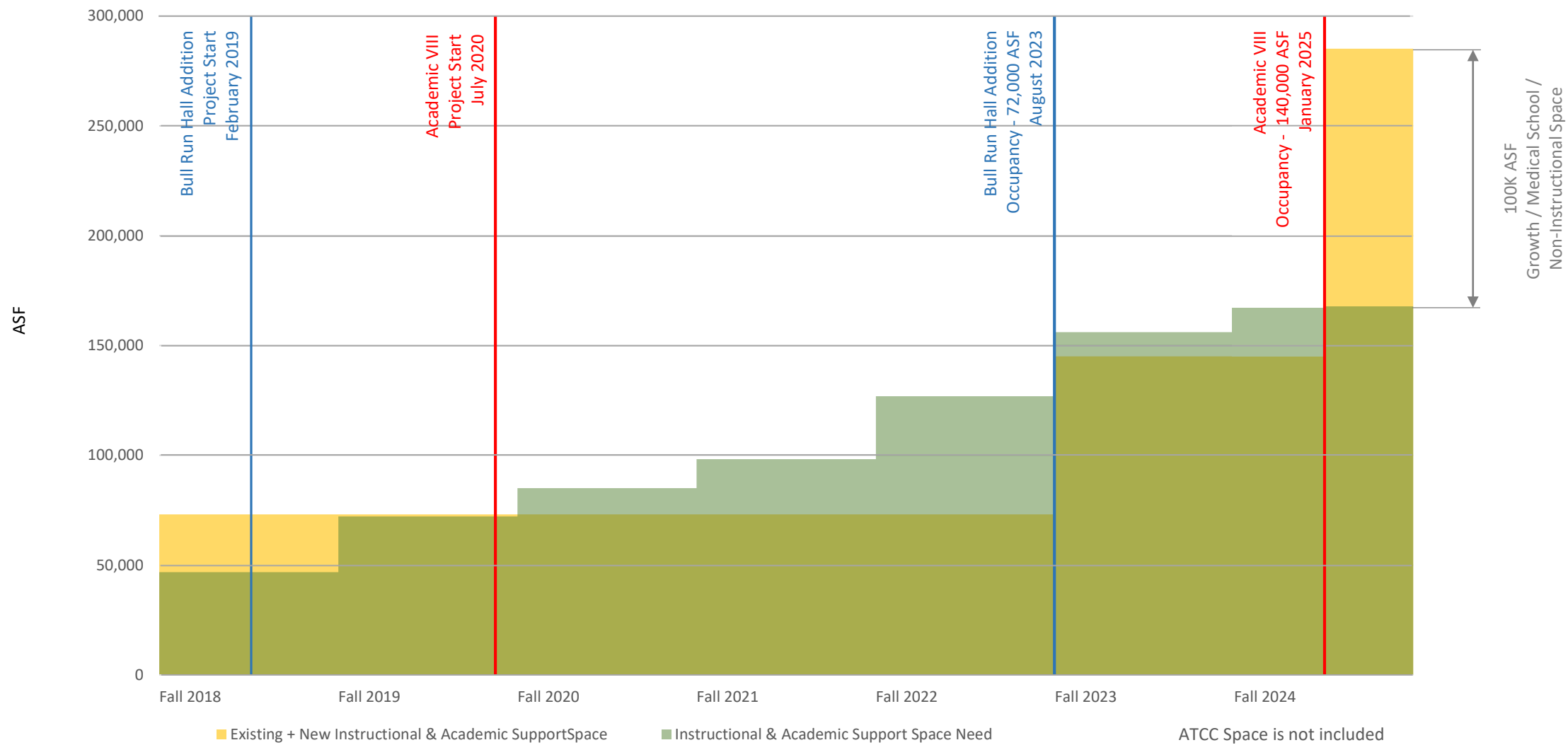



Roles & Responsibilities: Building Committee

Building Committee

CEHD	Banville, Dominique
COS	McVicker, Carrie
CVPA	Nam, Sang
VSE	Durant, Liza Wilson
Research	Crawford, Deb
Research	Hazel, Bill
Provost/Facilities	Manno, Laura
Facilities	Lipscomb, Doug



Roles & Responsibilities: Stakeholders

CEHD	Ginsberg, Mark	VSE	Barton, Oscar (ME)	VSE	Manitius, Andre (IST)
CEHD	Caswell, Amanda	VSE	Jeff Moran (ME)	VSE	Farrell, Pete (IST)
CEHD	Stroiney, Debra	VSE	Colin Reagle (ME)	VSE	Khondkar Islam (IST)
CEHD	Ford, Martin	VSE	Pei Dong (ME)	VSE	Irene Bruno (IST)
CEHD	Banville, Dominique	VSE	Johnnie Hall (ME)	VSE	Pouyan Ahmadi (IST)
CEHD	Caswell, Shane	VSE	Elizabeth Lattanzi (ME)	VSE	Liz White (CS)
COS	O'Toole, Mary Ellen	VSE	Ramin Bighamian (ME)	VSE	Mark Snyder (CS)
COS	Falsetti, Tony	VSE	Pilgyu Kang (ME)	VSE	Craig Yu (CS)
COS	Weatherspoon, Gerald	VSE	Ali Behesheti (ME)	VSE	Jyh-Ming Lien (CS)
COS	Grant, Gerry	VSE	Erik Knudsen (ME)	VSE	Yotam Gingold (CS)
COS	McVicker, Carrie	VSE	Mehdi Amiri (ME)	VSE	Zoran Duric (CS)
COS	Vaisman, Iosif	VSE	Urgessa, Girum (CEIE)	VSE	Sean Luke (CS)
COS	Rockwood, Larry	VSE	Caroline Hoemann (BIOE)	VSE	Parth Pathak (CS)
COS	Wescoat-Andes, Martha	VSE	Carolina Salvador Morales (BIOE)	VSE	Jones, Jim (CYSE)
CVPA	Nam, Sang	VSE	Remi Veneziano (BIOE)	VSE	Setia, Sanjeev (CS)
CVPA	Davis, Rick	VSE	Shani Ross (BIOE)	Research	Crawford, Deb
CVPA	Martin, Scott	VSE	Juan Cebal (BIOE)	Research	Hazel, Bill
CVPA	Casey, James	VSE	Siddhartha Sikdar (BIOE)	ITS	Allen, Ben
VSE	Durant, Liza Wilson	VSE	Qi Wei (BIOE)	ITS	Clemons, Crystal
VSE	Pyster, Art	VSE	Vicky Ikonomidou (BIOE)	EHSRM	Didier, Paul
VSE	Rose, Joyce	VSE	Buschmann, Michael (BIOE)	Registrar	Xiong, Pheng



Roles & Responsibilities: Facilities Staff Support

Facilities Staff Support

Planning	Manno, Laura
Project Mgmt.	Steele, Virginia
Interiors	Brady, Debbie
Facilities Mgmt.	Drerenberger, Tad
Space Mgmt.	Staulcup, Joy
PD&C	Lipscomb, Doug





Schedule

Phase	Programming	Schematic Design	Preliminary Design	Working Drawings	Permitting & Bidding	Construction
Durations	3 Months May 2019- August 19	3 Months August 2019- November 2019	4 Months November 2019- March 2020	5 Months March 2020- August 2020	5 Months August 2020- January 2021	27 Months January 2021- June 2023
Key Meetings	Work Session #1: May 20 -21 Work Session #2: June, 10-12 Work Session #3: July 9-11					
User Tasks	Identify Needs Define Activities Specify Specialized Equipment					

A man and a woman are sitting at a desk, smiling and looking at a laptop. The man is on the left, leaning forward with his chin on his hand. The woman is on the right, holding a yellow highlighter. They are in a modern office with large windows in the background. The image has an orange overlay.

THE SPACE PROGRAMMING PROCESS

Student Engagement

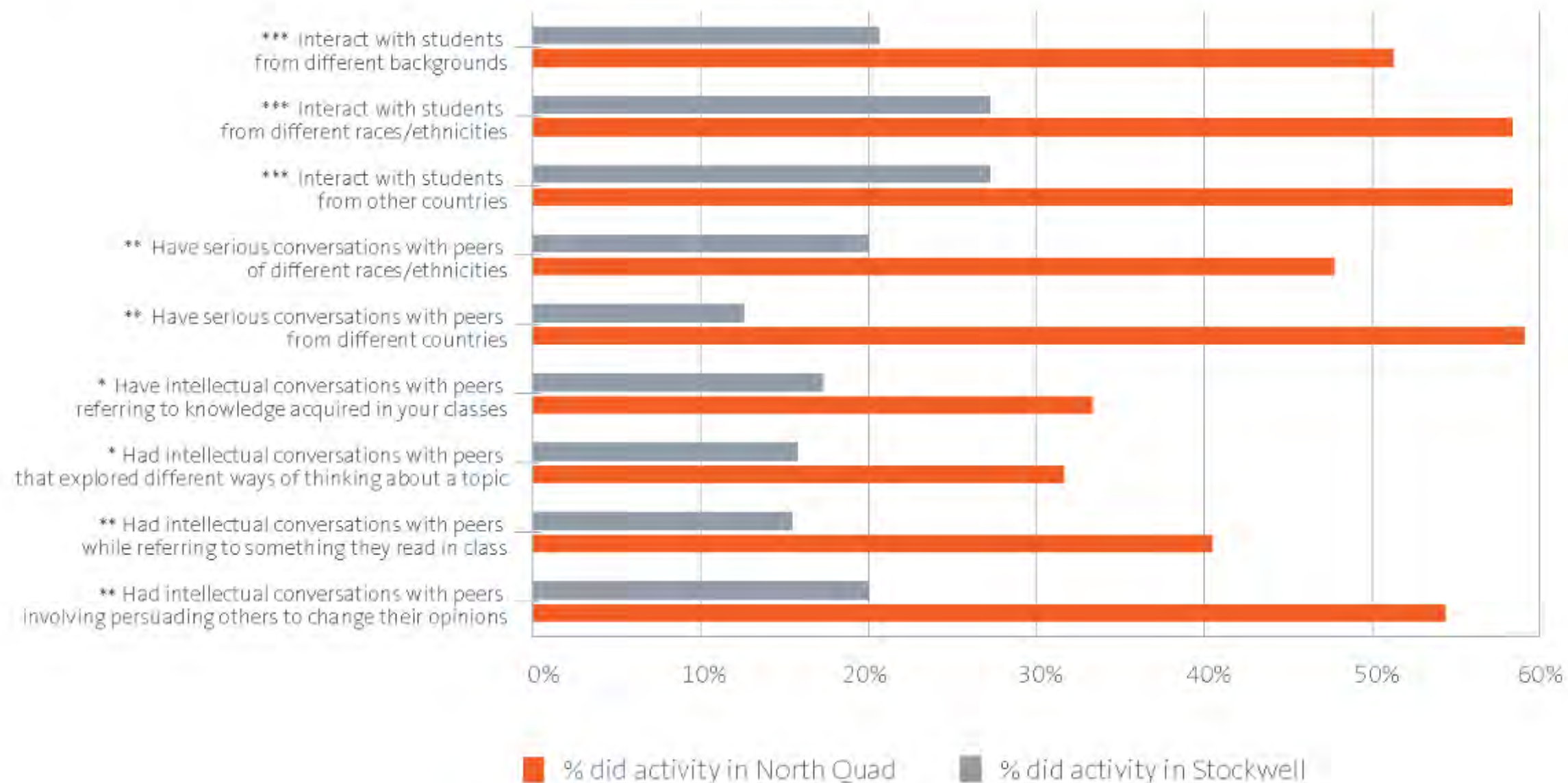

Anticipated Stakeholder Groups

- Instructional Wet Labs & Support Spaces
- Instructional Wet Labs – Bio or Chem Intensive
- Instructional Cadaver Lab & Support Spaces
- Other Medical Education Instructional Labs & Spaces
- Instructional Dry Labs & Support Spaces
- Instructional Computer Labs
- Virtual Reality &/or Animation & Support Spaces
- Human Performance/Physiology/Motion Capture
- Student Design Spaces
- Classrooms
- Collaboration Spaces
- Facilities Staff
- Building Committee
- Discovery - ATCC



Project Kickoff

- (REDS) DE...
- INTERCONNECTED PROGRAMS
- PUBLIC HEALTH LIVES LIES
- PUBLIC WORK W/ ENVIRONMENT
- FOUNDED LEARNING - TESLA
- WORKING TOGETHER COLLECTIVELY
- COLLECTIVE OWNERSHIP / PRIDE
- PUBLIC / PRIVATE
- PUBLIC HELPS MAKE THIS PLACE WHAT IT IS...
- WTF PRIDE
- EMPOWERING... HEALTHY... COLLABORATIVE
- SAFE / WELCOME / SECURE
- HEALTH TIES IT ALL TOGETHER.."
- FLEXIBLE / EASY TO MAINTAIN
- COST-CONSCIOUS
- INNOVATIVE
- CHALLENGE COUNTRY HOW TO RESPOND WITHIN BOUND

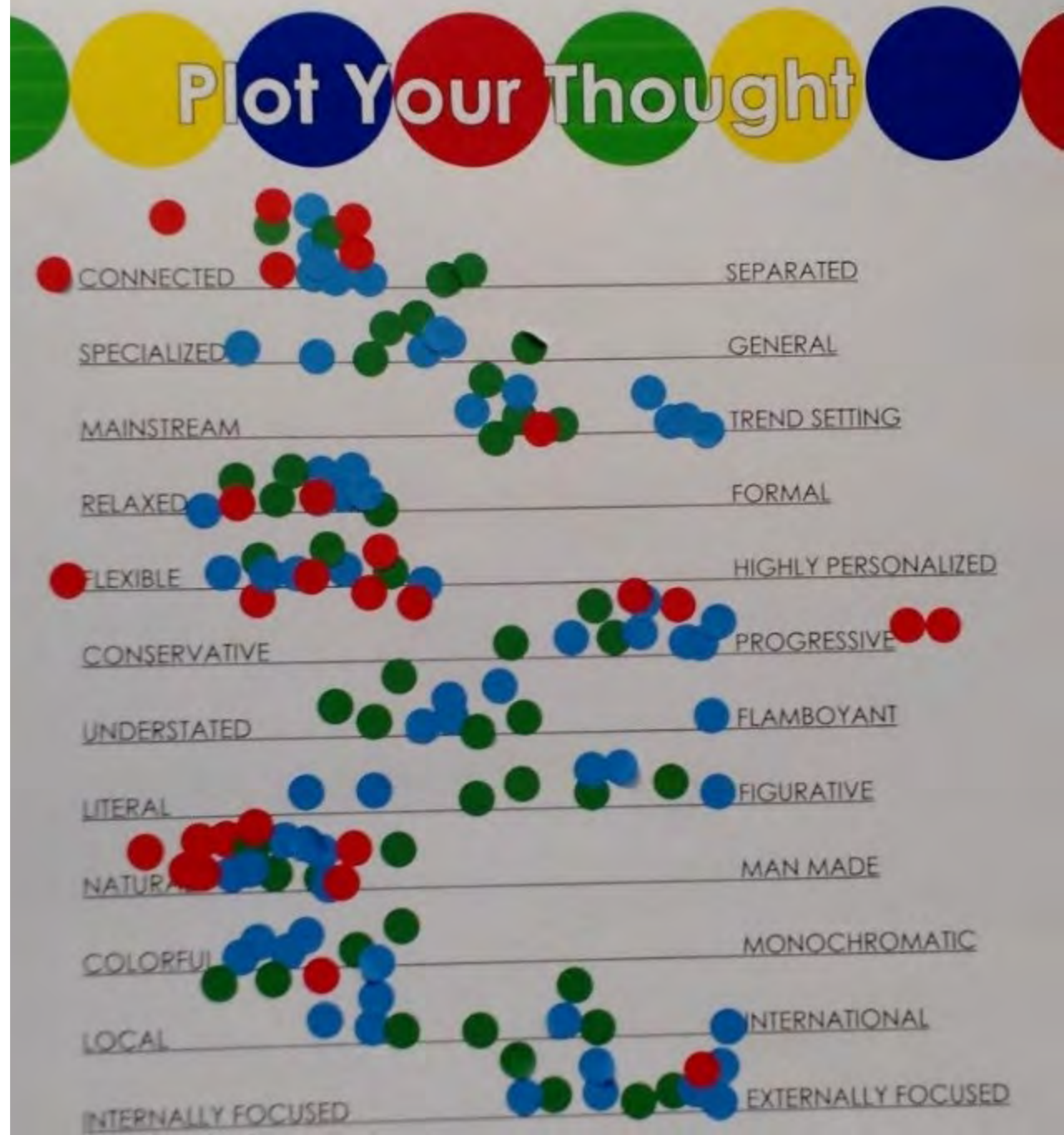



1

UNDERSTAND

2

EXPLORE

3

ALIGN

4

REALIZE

UNDERSTAND

1

UNDERSTAND

2

EXPLORE

3

ALIGN

4

REALIZE

Program Space Requests for Bull Run Addition & Backfill Project

New Addition Scope - Proposed (some additional program adjustment may be required)

9/18/2017 - Final Planning Program

New Addition Program

Item	QTY	Size	Total ASF	Comments	Stakeholders
Specialized Wet Labs (Proposed)					
Instructional wet lab - general	1	3000	3,000	aero, fluids, environmental, chemistry, EHS, forensics, others?	VSE-CoS-CEHD-EHS
Instructional wet lab - general	1	3000	3,000	aero, fluids, environmental, chemistry, EHS, forensics, others?	VSE-CoS-CEHD-EHS
Instructional wet lab - general	1	1400	1,400	aero, fluids, environmental, chemistry, EHS, forensics, others?	VSE-CoS-CEHD-EHS
Instructional Wet lab - bio-intensive	1	3000	3,000	biology, biochemistry, biomedical engineering, UHSUS, G2, kinesiology, forensics, others?	VSE-CoS-CEHD-EHS
Instructional wet lab - chemistry-intensive	1	1800	1,800	biology, biochemistry, biomedical engineering, UHSYS, organic/synthetic chemistry, others?	CoS-VSE
Cadaver Intake and processing	1	400	400	forensics, UHSUS, biology, biomedical engineering, G2, kinesiology, others?	CoS-VSE-CEHD
Cadaver Lab	1	2600	2,600	forensics, UHSUS, biology, biomedical engineering, G2, kinesiology, others?	CoS-VSE-CEHD
Photography Lab	1	300	300	Studio for development of film	CoS-CVPA-CEHD-VSE
<i>Specialized Wet Lab Requests - Total</i>			15,500		
Specialized Dry Labs (Proposed)					
Dry lab - general	1	3000	3,000	mechanics, manufacturing, materials, robotics, others?	VSE-CoS-CVPA
Dry lab - general	1	3000	3,000	manufacturing, making, robotics, others?	VS-CoS
Dry lab - general	1	3000	3,000	manufacturing, making, robotics, others?	VSE-CoS
Dry lab - general	1	1000	1,000	forensics, others?	CoS?
Computer lab - general	1	2500	2,500	cybersecurity, networking, machine learning/analytics, computer game design, computational science/engineering, others?	VSE-CoS-CVPA
Computer lab - general	1	2500	2,500	cybersecurity, networking, machine learning/analytics, computer game design, computational science/engineering, others?	VSE-CVPA-CoS
Computer lab - general	1	960	960	cybersecurity, networking, machine learning/analytics, computer game design, computational science/engineering, others?	VSE-CVPA-CoS
Computer lab - virtual reality	1	1500	1,500	computer game design, human machine interfaces, scientific visualization, others?	CVPA-VSE-CoS
Computer lab - virtual reality and exhibits	1	3000	3,000	computer game design, visualization exhibits, shows, competitions, fund raisers, others?	CVPA-VSE-CoS
Audio post-production lab	1	1200	1,200	computer game design	CVPA-VSE-CoS
Animation lab	1	900	900	computer game design, human-machine interfaces, scientific visualizations, others?	CVPA-VSE-CoS
Motion capture lab	1	1500	1,500	computer game design, information technology, physiology and human performance, biomechanics	CVPA-CEHD-VSE
Physiology dry lab	1	10500	10,500	human performance kinesiology, biomechanics, biology, biomedical engineering, UHSUS, others?	CEHD-VSE-CoS
Open Student Design Space	1	4000	4,000	Will require sink, highly flexible, reconfigurable space to support student design competitions, capstone projects, others?	VSE-CVPA-CEHD-CoS
Open Student Design Space	1	4000	4,000	Will require sink, highly flexible, reconfigurable space to support student design competitions, capstone projects, others?	VSE-CVPA-CEHD-CoS
<i>Specialized Dry Lab Requests - Total</i>			42,560		

EXPLORE

1

UNDERSTAND

2

EXPLORE

3

ALIGN

4

REALIZE



2

EXPLORE

SPECIALIZED WET LABS (PROPOSED)



SPECIALIZED DRY LABS (PROPOSED)



UNIVERSITY CLASSROOMS



COLLABORATION



SHARED WORK SPACE



SUPPORT



ROOM USE LEGEND

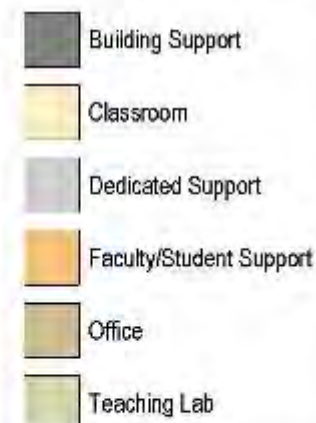

ALIGN

1

UNDERSTAND

2

EXPLORE

3

ALIGN

4

REALIZE

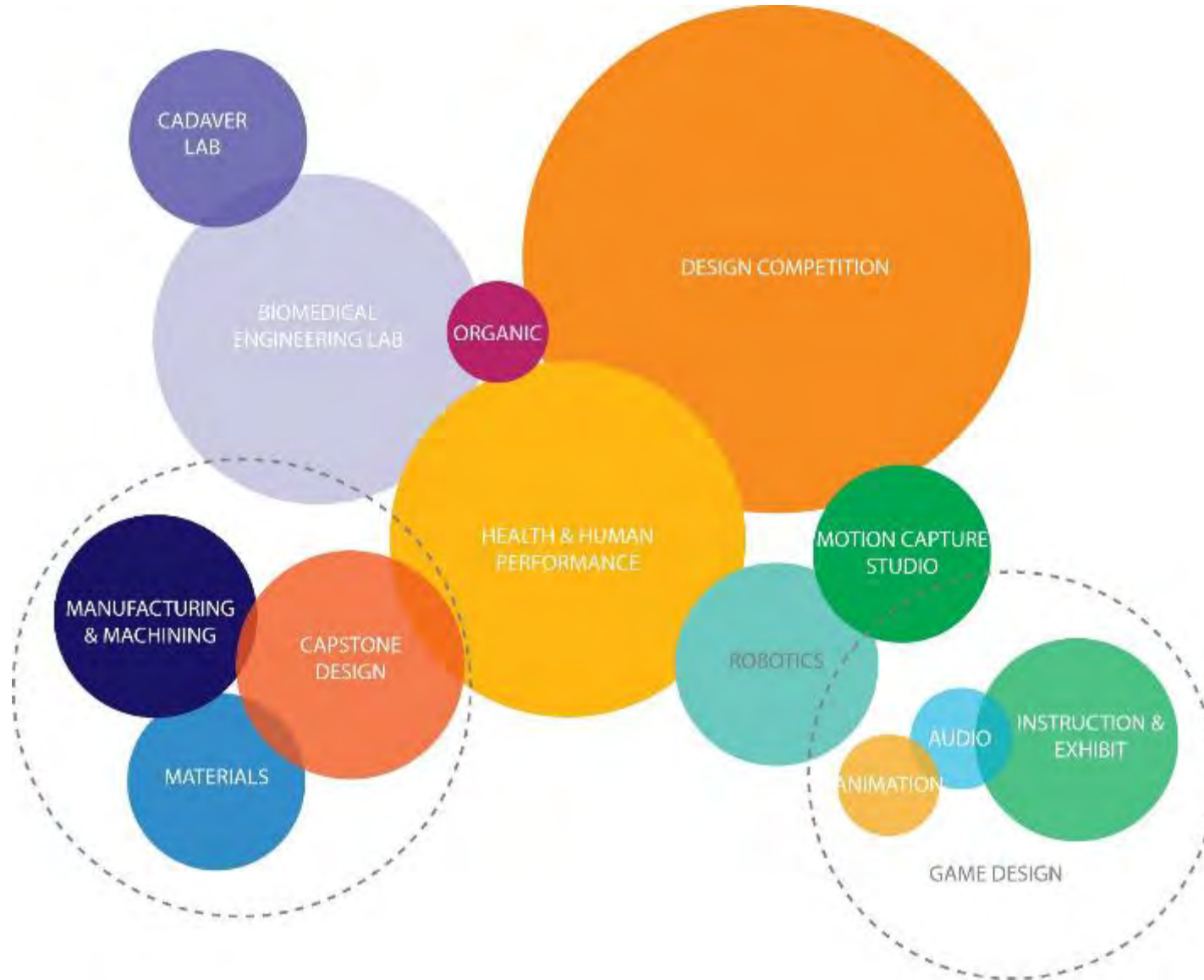



Department	Net Area	Gross Area
Biology	24,365sf	39,000sf
Chemistry	23,750sf	38,000sf
Computer Science	6,100sf	9,700sf
Engineering	27,725sf	44,400sf
Psychology	9,800sf	15,400sf
Shared Clusters	14,730sf	23,600sf
Shared Classrooms	10,410sf	16,700sf
Mechanical		17,400sf
Total		204,200sf

Building Gross Areas	
Cowles 4 @ 18,300sf	73,200sf
New Construction +/- 4.25 @ 31,000sf	+/-131,000sf
Total	204,200sf

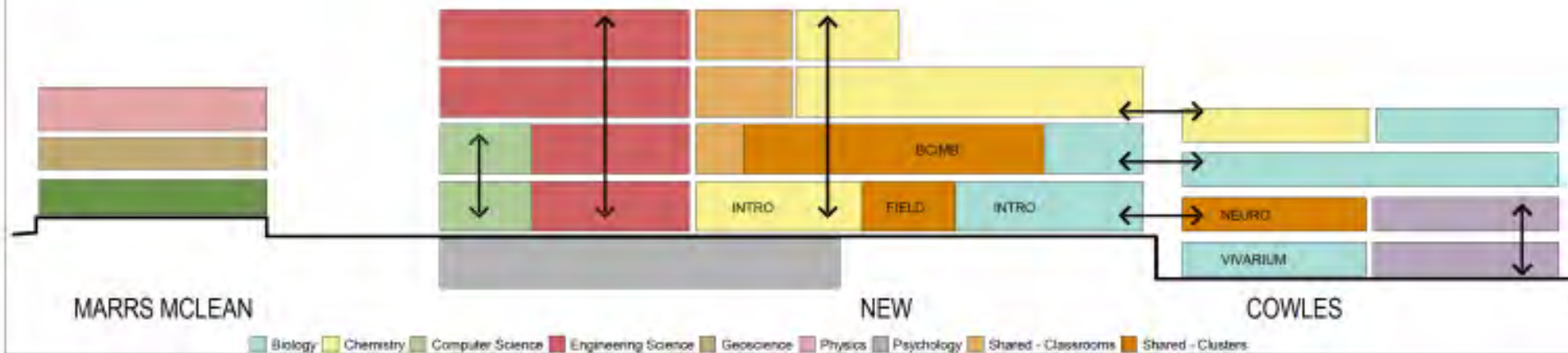

EYP/



3
ALIGN

REALIZE

1

UNDERSTAND

2

EXPLORE

3

ALIGN

4

REALIZE

Dept. Code	Space Number	Space Name	Space Needs	Required Adjacencies	# Fume Hoods	# Laminar flow hoods	# of stations	Station Size	# Spaces Req'd	Size Req'd	Net Square Feet Area
------------	--------------	------------	-------------	----------------------	--------------	----------------------	---------------	--------------	----------------	------------	----------------------

2 Teaching and Research Laboratories - Low Bay

Laboratories

2.01	Electronics Teaching Lab	Shared (2 per) workstations with common electronic instrument, tools, power strips, soldering station, magnifier lights, solder vapor filter	Electronic Instrumentation Lab	0		12	6'x3'	1	1,300	1,300
2.02	Electronics Instrumentation Lab	Workbenches for electronic repair, storage cabinets, bench top soldering	Electronics Teaching Lab					1	500	500
2.03	Microbiology Teaching Lab	bench space and open area for lab activities with larger pilot scale equipment, storage, visible from the corridor	Shared Support	2		16	3 LF per stud.	1	1,300	1,300
2.04	Microbiological Engineering Lab	teaching and research groups, 8 research and 10-15 students in teaching, Class 100,000, Biosafety level 2, visible from the corridor.	Shared Support, PI and Graduate Students	1	1			1	1,300	1,300
2.05	Fermentation Research Lab	class 100,000, Biosafety level 2, bench top equipment and open area for equipment, visible from the corridor.	Shared Support, PI and Graduate Students	1	1			1	500	500
2.06	Microbiology/Fermentation lab	5-10 researchers, 10-15 students for teaching, 2 biosafety hoods, a separate room for Biosafety cabinets and equipment, adjacent and connected to the lab area. Visible from the corridor	Shared support, Biomass receiving, Bioprocessing and Graduate Students	2	1			1	1,300	1,300

4

REALIZE

Spatial Adjacencies

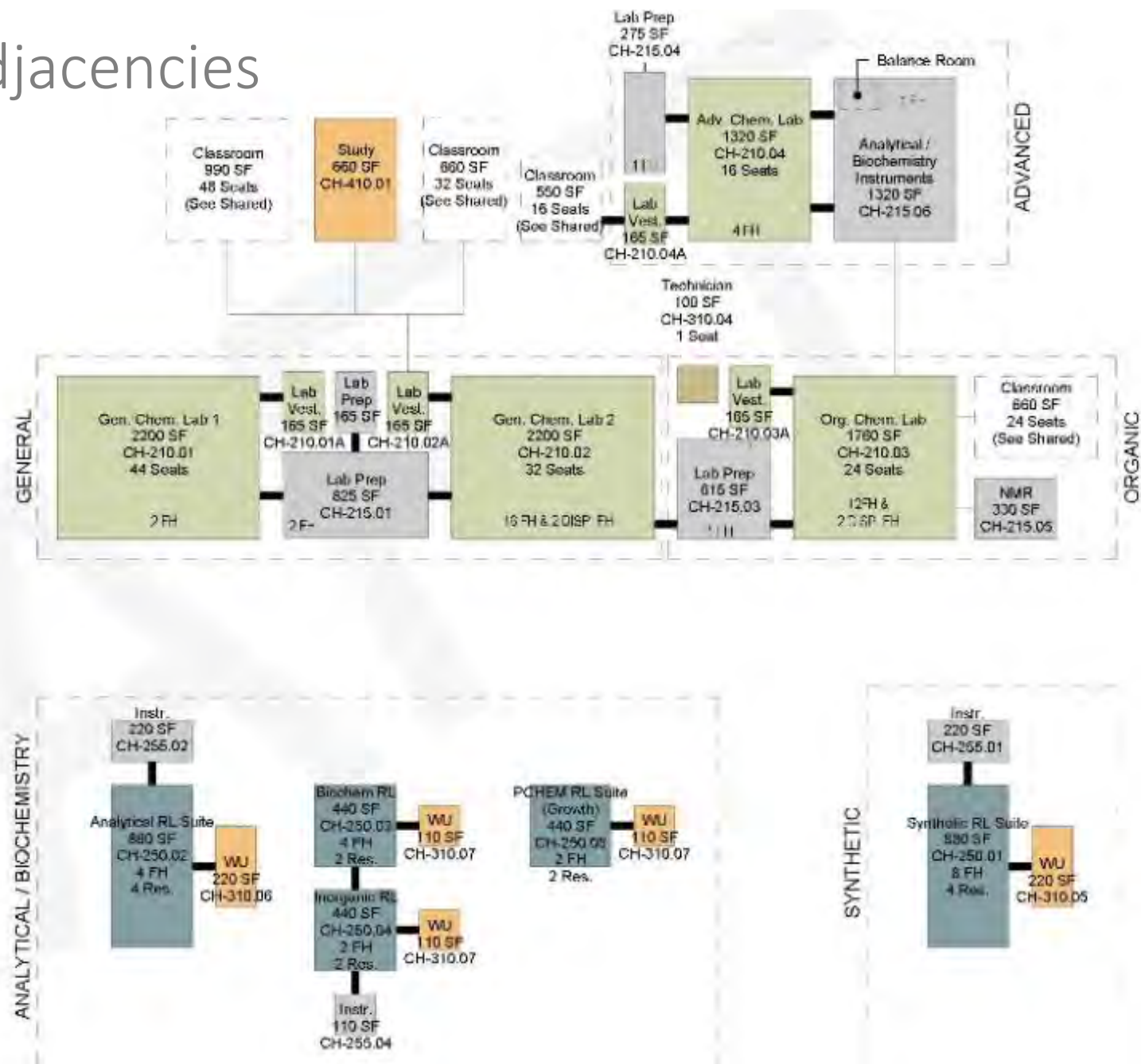



SPACE TYPES



Multi-Disciplinary Teaching Laboratories

Biology

- Groups of 2 or 4

Chemistry

- Groups of 3

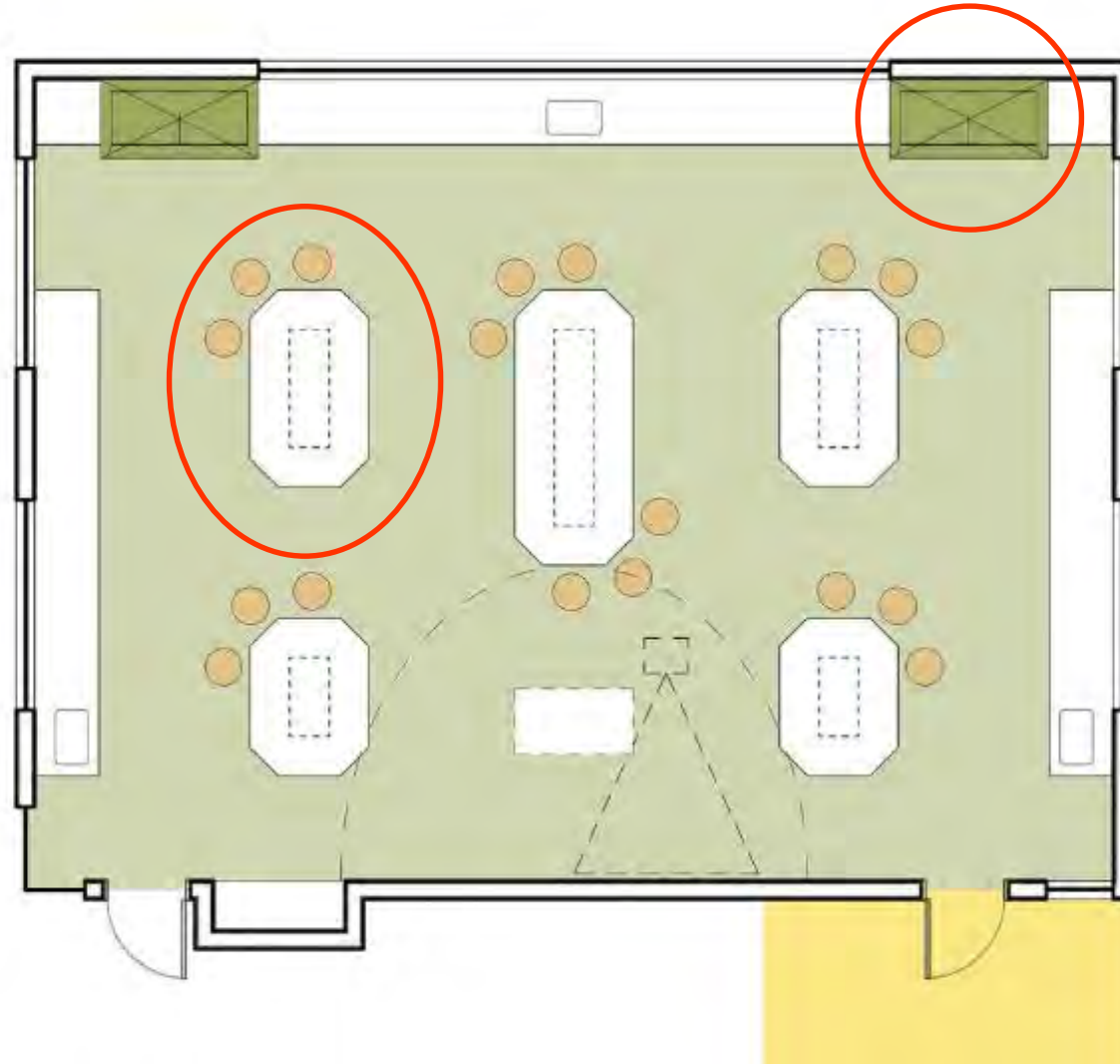

/ Multi-Disciplinary





Interdisciplinary Science

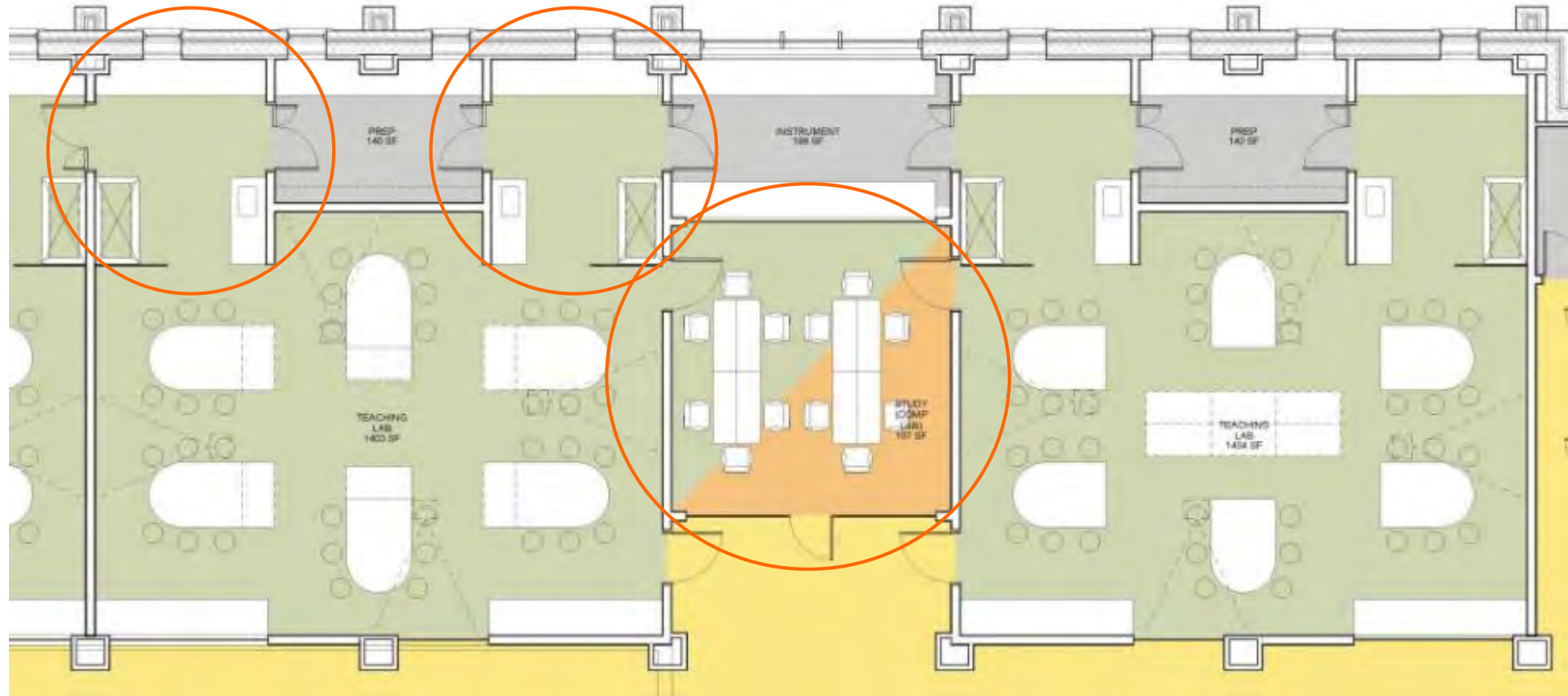

































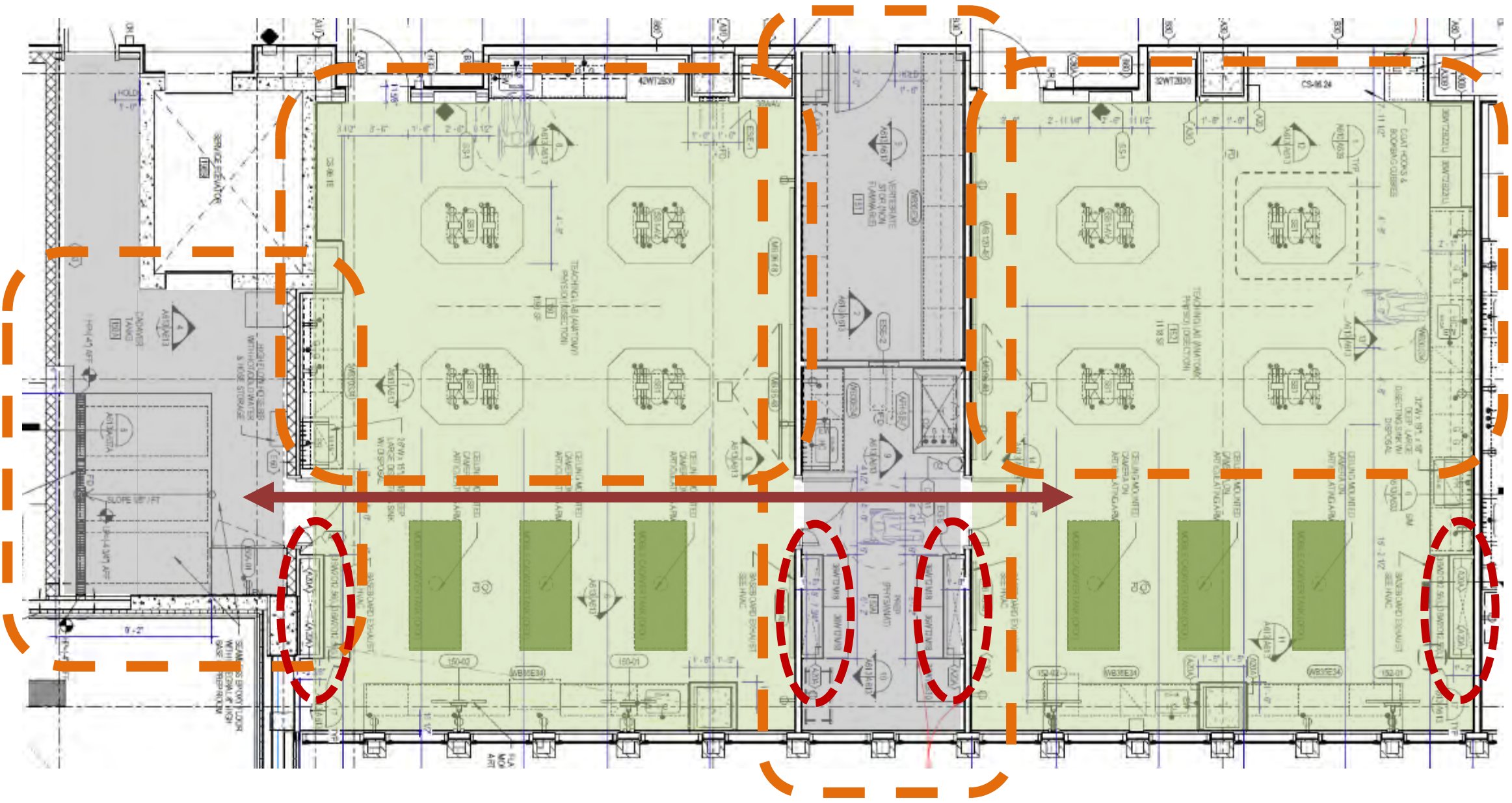





Collaboration Areas @ 25 Colleges & Universities

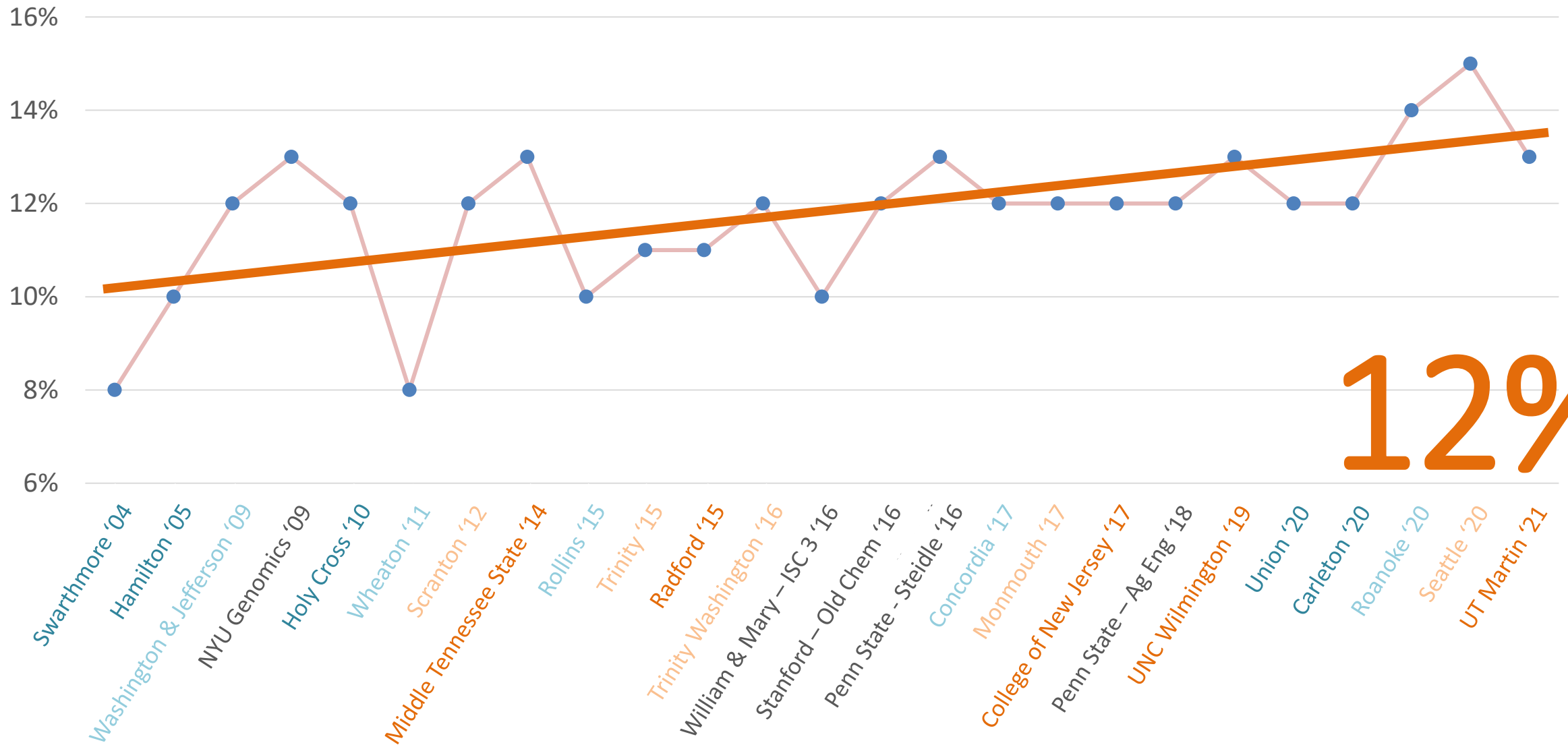



/ Enclosed, Scheduled



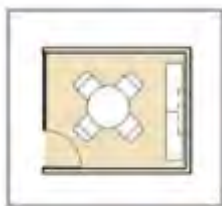

/ Enclosed, Unscheduled





/ Open, Informal





PROJECT OVERVIEW

Project Definition



72,000 ASF

Bull Run Hall Addition Program Summary	
Total Gross SF of Building (GSF)	100,000
State-mandated efficiency factor (72%)	0.72
Total Assignable SF for Allocation (ASF)	72,000
Bull Run Hall Addition Program Breakdown	
Specialed Wet Labs - Instructional	15,500
Specialized Dry Labs - Instructional	42,560
Shared Work Space	2,706
University Classrooms	9,080
Meeting & Conference	2,300
Specialized Building & Support Space	640
Total Assignable SF (ASF)	72,786

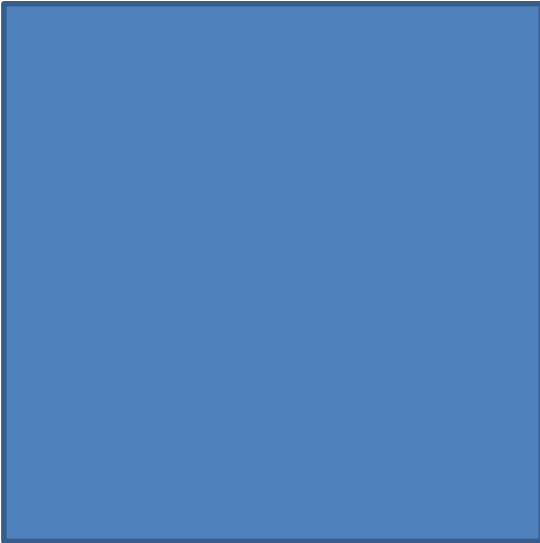

132,000ASF

Academic VIII Program Summary	
Total Gross SF of Building (GSF)	200,000
State-mandated efficiency factor (66%)	0.66
Total Assignable SF for Allocation (ASF)	132,000
Academic VIII Program Breakdown	
Academic & Instructional Support	111,000
Student Services & Support (E&G Funded)	10,000
Admin/ Central Services & Support (E&G Funded)	11,000
Total Assignable SF (ASF)	132,000

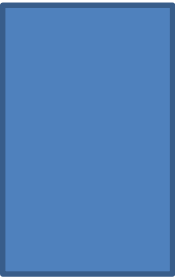

24,000 ASF

Discovery Hall - Current ATCC Space	
Total Assignable SF of Building (ASF)	23,874
Vacated by ATCC July 2020	16,688
Vacated by ATCC January 2021	7,186
Discovery Hall - Current ATCC Space Program Breakdown	
Wet Labs & Lab Support Spaces (vacated July 2020)	11,700
Office & Office Support Spaces (vacated July 2020)	4,988
Dry Research Lab (vacated Jan 2021)	696
Office & Office Support Spaces (vacated Jan 2021)	6,490
Total Assignable SF (ASF)	23,874

Sci Tech Future Program Needs

SCHEV E&G Student Service/Support Departments

<i>Division</i>	<i>Department Name</i>	<i>FX ASF</i>	<i>FX FTE (Fall 2018)</i>	<i>ASF/FTE</i>	<i>SciTech FTE (6- yr Plan)</i>	<i>Calculated ASF</i>	<i>Sci/Tech Current ASF</i>	<i>Remaining ASF Need</i>
Provost	MIX Admin/Operations	20,491	22,869	0.90	3,550	3,181	0	3,181
Provost	Global Education Office	3,348	22,869	0.15	3,550	520	0	520
Provost	Office of Undergrad Educ/OSCAR	2,352	22,869	0.10	3,550	365	0	365
Provost	Admiss-Office of Military Svcs	972	22,869	0.04	3,550	151	0	151
Provost	Admissions	14,612	22,869	0.64	3,550	2,268	0	2,268
Provost	Ctr Acad Advising, Retent, Transition	4,173	22,869	0.18	3,550	648	0	648
Provost	Enrollment Central	753	22,869	0.03	3,550	117	153	-36
Provost	Student Financial Aid	5,094	22,869	0.22	3,550	791	0	791
Provost	Office of the Registrar	6,951	22,869	0.30	3,550	1,079	1,234	-155
University Life	Career Services	7,341	22,869	0.32	3,550	1,140	0	1,140
Fnan & Admin	Student Accounts	3,698	22,869	0.16	3,550	574	0	574
Fnan & Admin	Cash Office and ALM	1,493	22,869	0.07	3,550	232	0	232
		71,278				11,065	1,387	9,678

Sci Tech Future Program Needs

SCHEV E&G Admin/Central Service/Support Departments

<i>Division</i>	<i>Department Name</i>	<i>FX ASF</i>	<i>FX FTE (Fall 2018)</i>	<i>ASF/FTE</i>	<i>SciTech FTE (6- yr Plan)</i>	<i>Calculated ASF</i>	<i>Sci/Tech Current ASF</i>	<i>Remaining ASF Need</i>
Provost	Sponsored Programs Administration	6,867	22,869	0.30	3,550	1,066	0	1,066
Provost	Provost Administration	12,679	22,869	0.55	3,550	1,968	0	1,968
Provost	Stearns Ctr for Teaching/Learning	3,849	22,869	0.17	3,550	597	226	371
Provost	Inst Assessment, Research & Effectiveness	2,330	22,869	0.10	3,550	362	0	362
Provost	Executive and Professional Education	-	22,869	0.00	3,550	0	1,134	-1,134
Fnan & Admin	Office Compliance, Diversity, Ethics	3,205	22,869	0.14	3,550	498	0	498
Fnan & Admin	SEERM / Environ Hlth & Safety	5,897	22,869	0.26	3,550	915	3,519	-2,604
Fnan & Admin	ITS (LSS) - Classroom & Lab Tech/Design	16,028	22,869	0.70	3,550	2,488	3,199	-711
Fnan & Admin	ITS (ESD) - Technology Support Svcs	5,487	22,869	0.24	3,550	852	750	102
Fnan & Admin	ITS (LSS) - Learning Support Svcs	11,028	22,869	0.48	3,550	1,712	389	1,323
Fnan & Admin	ITS (ISO) - Information Security	1,690	22,869	0.07	3,550	262	0	262
Fnan & Admin	ITS (AS) - GMU-TV	5,653	22,869	0.25	3,550	878	0	878
Fnan & Admin	ITS - Admin/Shared Space	4,148	22,869	0.18	3,550	644	0	644
Fnan & Admin	ITS (EA) - Enterprise Applications	5,186	22,869	0.23	3,550	805	0	805
Fnan & Admin	ITS (EIS) - Ent Servers & Messaging/Data Ctr	8,518	22,869	0.37	3,550	1,322	0	1,322
Fnan & Admin	ITS (EIS) - Network Engr & Tech/Collab Video Tech	6,475	22,869	0.28	3,550	1,005	0	1,005
Fnan & Admin	ITS (ESD) - Strategic Business Ops	3,468	22,869	0.15	3,550	538	0	538
Fnan & Admin	Accounts Payable Department	2,299	22,869	0.10	3,550	357	0	357
Fnan & Admin	Purchasing Office	2,430	22,869	0.11	3,550	377	0	377
Fnan & Admin	Human Resources Administration	13,332	22,869	0.58	3,550	2,070	0	2,070
Fnan & Admin	Police & Public Safety	7,261	22,869	0.32	3,550	1,127	1,190	-63
Facilities	Facilities Mgmt Admin	5,180	22,869	0.23	3,550	804	3,826	-3,022
Facilities	Central Warehouse	21,078	22,869	0.92	3,550	3,272	0	3,272
Facilities	EQE-Central Heat/Cooling Plant	1,175	22,869	0.05	3,550	182	0	182
Facilities	Waste Management/Recycling	939	22,869	0.04	3,550	146	0	146
Comm & Mktg	Information Services	2,848	22,869	0.12	3,550	442	90	352
Comm & Mktg	University Events (office/support)	2,388	22,869	0.10	3,550	371	0	371
		161,438				25,061	14,323	10,738

Sci Tech Future Program Needs

SCHEV Auxiliary Student Service/Support Departments

<i>Division</i>	<i>Department Name</i>	<i>FX ASF</i>	<i>FX FTE (Fall 2018)</i>	<i>ASF/FTE</i>	<i>SciTech FTE (6- yr Plan)</i>	<i>Calculated ASF</i>	<i>Sci/Tech Current ASF</i>	<i>Remaining ASF Need</i>
University Life	Office of Student Involvement-Campus Life	8,523	22,869	0.37	3,550	1,323	0	1,323
University Life	Student Government	893	22,869	0.04	3,550	139	0	139
University Life	Graduate Student Life Office	157	22,869	0.01	3,550	24	0	24
University Life	Student Organizations	1,908	22,869	0.08	3,550	296	0	296
University Life	Office of Internatl Programs & Svcs	3,167	22,869	0.14	3,550	492	0	492
University Life	Student Media Group	7,395	22,869	0.32	3,550	1,148	0	1,148
University Life	Diversity/Inclusion/Multicult Ed & LGBTQ Resources	4,991	22,869	0.22	3,550	775	0	775
University Life	Student Health Services	9,464	22,869	0.41	3,550	1,469	1,130	339
University Life	Student Support & Advocacy Center	2,986	22,869	0.13	3,550	464	0	464
University Life	Counseling & Psychological Services	7,502	22,869	0.33	3,550	1,165	0	1,165
University Life	Learning Services	1,388	22,869	0.06	3,550	215	0	215
University Life	Early Identification Program	2,906	22,869	0.13	3,550	451	0	451
University Life	New Student & Family Programs	3,686	22,869	0.16	3,550	572	0	572
University Life	Office of Disability Services	3,726	22,869	0.16	3,550	578	0	578
University Life	University Life Admin & Programs	9,826	22,869	0.43	3,550	1,525	1,757	-232
University Life	Leadership Educ/Devel (LEAD)	1,467	22,869	0.06	3,550	228	0	228
University Life	Office Acad Integrity/Student Conduct	2,776	22,869	0.12	3,550	431	0	431
University Life	Off-Campus Student Services	759	22,869	0.03	3,550	118	0	118
		73,520				11,413	2,887	8,526

Sci Tech Future Program Needs

SCHEV Auxiliary Admin/Central Service/Support Departments

<i>Division</i>	<i>Department Name</i>	<i>FX ASF</i>	<i>FX FTE (Fall 2018)</i>	<i>ASF/FTE</i>	<i>SciTech FTE (6- yr Plan)</i>	<i>Calculated ASF</i>	<i>Sci/Tech Current ASF</i>	<i>Remaining ASF Need</i>
Fnan & Admin	Photo ID/Card Office*	798	22,869	0.03	3,550	124	0	124
Fnan & Admin	CASO-Card Access/Security Office	861	22,869	0.04	3,550	134	0	134
Fnan & Admin	Auxiliary Enterprise Administration	3,295	22,869	0.14	3,550	511	0	511
Fnan & Admin	Mail Room Operations	3,218	22,869	0.14	3,550	500	0	500
Fnan & Admin	Print Services Admin/Ops	5,080	22,869	0.22	3,550	789	1,000	-211
Fnan & Admin	Student Centers Admin	2,580	22,869	0.11	3,550	401	0	401
Fnan & Admin	Mason Bookstore/Computer Store-Barnes & Noble	20,997	22,869	0.92	3,550	3,259	1,189	2,070
Fnan & Admin	Transportation Administration	3,867	22,869	0.17	3,550	600	121	479
		40,696				6,317	2,310	4,007

Sci Tech Instructional & Academic Support Space – 3550 FTE

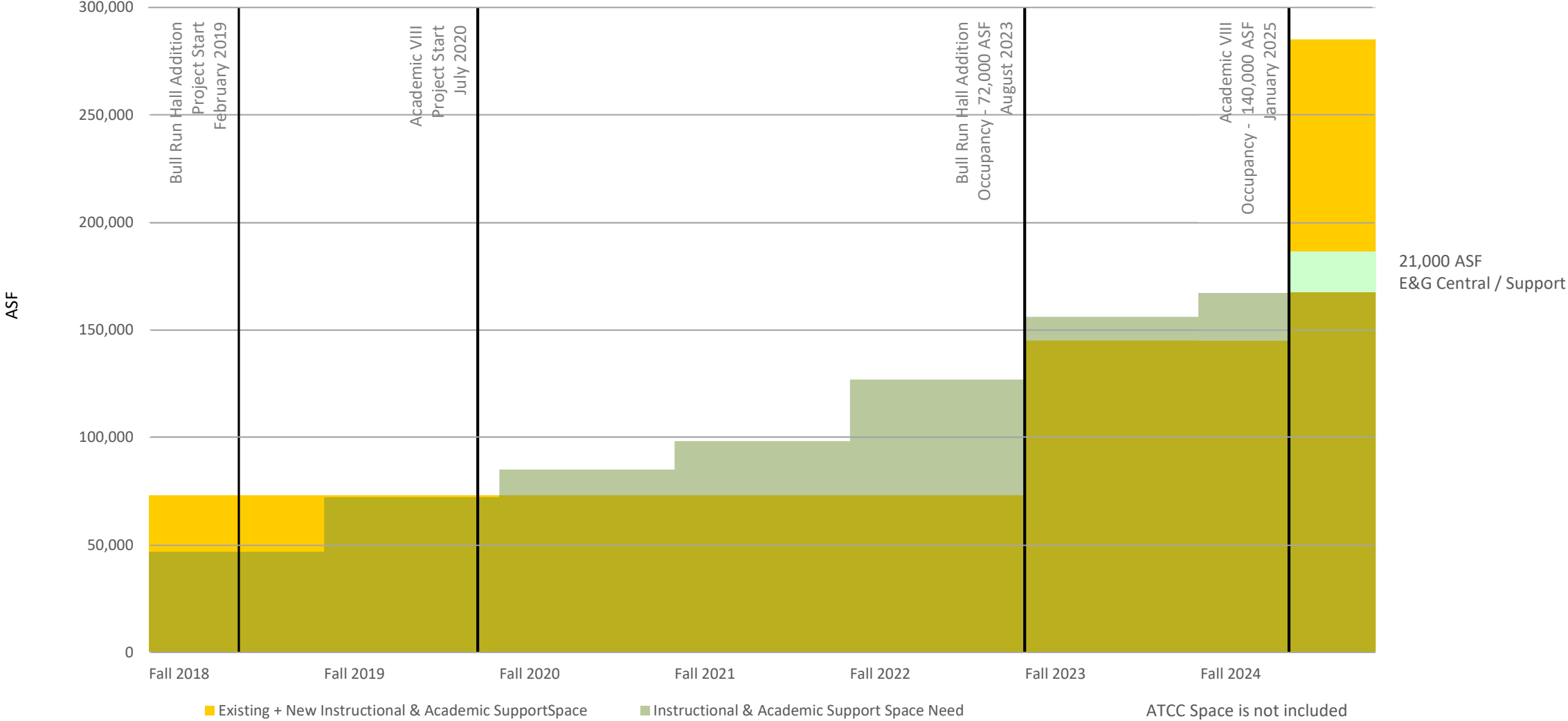

Bull Run Hall Addition – Specialized Spaces

Item	QTY	Size	Total ASF	Comments
Specialized Wet Labs (Proposed)				
Instructional wet lab - general	1	3000	3,000	aero, fluids, environmental, chemistry, EHS, forensics, others?
Instructional wet lab - general	1	3000	3,000	aero, fluids, environmental, chemistry, EHS, forensics, others?
instructional wet Lab - general	1	1400	1,400	aero, fluids, environmental, chemistry, EHS, forensics, others?
Instructional Wet lab - bio-intensive	1	3000	3,000	biology, biochemistry, biomedical engineering, UHSUS, G2, kinesiology, forensics, others?
Instructional wet lab - chemistry-intensive	1	1800	1,800	biology, biochemistry, biomedical engineering, USHYS, organic/synthetic chemistry, others?
Cadaver Intake and processing	1	400	400	forensics, UHSUS, biology, biomedical engineering, G2, kinesiology, others?
Cadaver Lab	1	2600	2,600	forensics, UHSUS, biology, biomedical engineering, G2, kinesiology, others?
Photography Lab	1	300	300	Studio for development of film
Specialized Wet Lab Requests - Total			15,500	
Specialized Dry Labs (Proposed)				
Dry lab - general	1	3000	3,000	mechanics, manufacturing, materials, robotics, others?
Dry lab - general	1	3000	3,000	manufacturing, making, robotics, others?
Dry lab - general	1	3000	3,000	manufacturing, making, robotics, others?
Dry lab - general	1	1000	1,000	forensics, others?
Computer lab - general	1	2500	2,500	cybersecurity, networking, machine learning/analytics, computer game design, computational science/engineering, ot
Computer lab - general	1	2500	2,500	cybersecurity, networking, machine learning/analytics, computer game design, computational science/engineering, ot
Computer lab - general	1	960	960	cybersecurity, networking, machine learning/analytics, computer game design, computational science/engineering, ot
Computer lab - virtual reality	1	1500	1,500	computer game design, human machine interfaces, scientific visualization, others?
Computer lab - virtual reality and exhibits	1	3000	3,000	computer game design, visualization exhibits,shows, competitions, fund-raisers, others?
Audio post-production lab	1	1200	1,200	computer game design
Animation lab	1	900	900	computer game design, human-machine interfaces, scientific visualizations, others?
Motion capture lab	1	1500	1,500	computer game design, information technology, physiology and human performance, biomechanics
Physiology dry lab	1	10500	10,500	human performancem kinesiology, biomechanics, biology, biomedical engineering, UHSUS, others?
Open Student Design Space	1	4000	4,000	Will require sink, highly flexible, reconfigurable space to support student design competitions, capstone projects, othe
Open Student Design Space	1	4000	4,000	Will require sink, highly flexible, reconfigurable space to support student design competitions, capstone projects, othe
Specialized Dry Lab Requests - Total			42,560	



/ QUESTIONS?





/ WORKSESSION

Goals Exercise

Collaborative Building:



College:



Personal:



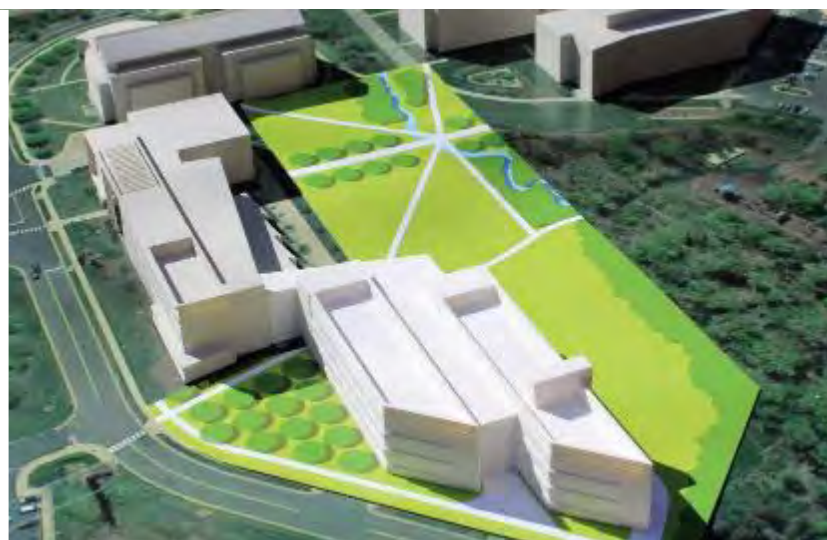

Designing innovative academic environments for student success

Project Definition – Discovery

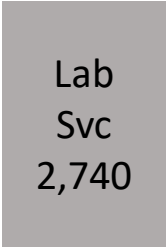

Project Definition – Bull Run Hall Addition



Project Definition – Academic VIII

Student Services &
Support
(E&G Funded)

10,000 nsf

Admin / Central
Services & Support
(E&G Funded)

11,000 nsf

Academic & Instructional Support

111,000 nsf